



190 Whiteway Road
, Bristol, BS5 7RP

Asking price £340,000



190 Whiteway Road



Description

Well presented 1930's home located in Speedwell close to local shops, schools and links to the city centre. This lovely home has much to offer and comprises of entrance porch, hallway, full length bay lounge dining room with patio doors. There's a modern fitted kitchen which gives access to a sunny conservatory, a great additional space!

Upstairs are three well proportioned bedrooms all with fitted wardrobes and a modern family bathroom. Outside to the rear is a low maintenance garden with a southerly aspect and access to a large garage with up and over door providing off street parking. To the front of the property is a block paved garden. (Please note there is not a dropped kerb so this is not official off street parking). Further benefits include gas central and double glazing. Please call to view!

- 1930'S TERRACE
- LOUNGE/DINER
- CONSERVATORY
- DOUBLE GARAGE
- DOUBLE GLAZING
- THREE BEDROOMS
- MODERN KITCHEN
- MODERN BATHROOM
- SOUTHERLY FACING GARDEN
- GAS CENTRAL HEATING





Floor Plan

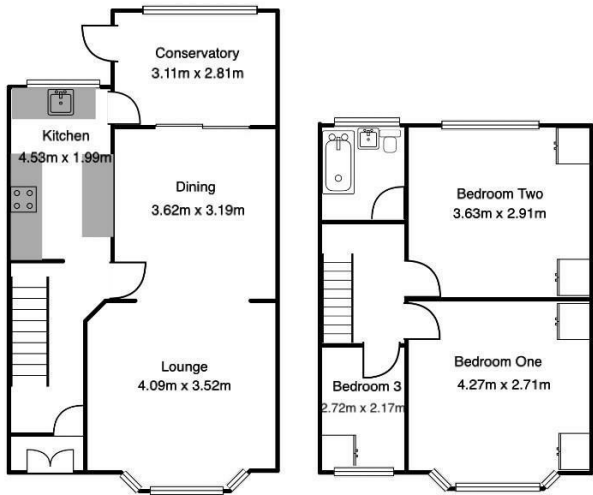

For illustration purposes only. Not to scale. - Drawplan

Area Map

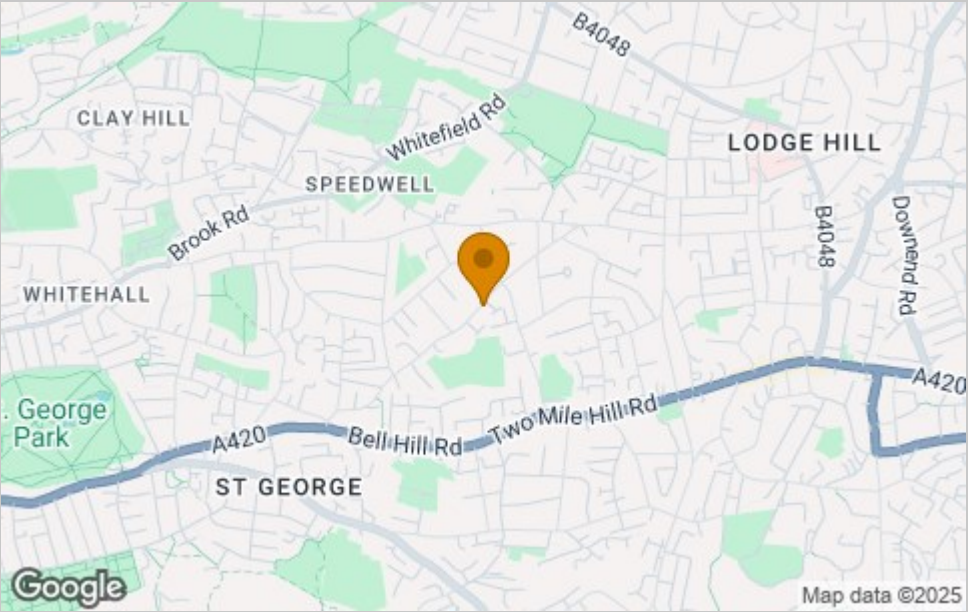

Viewing

Please contact our House + Co Property (Sales) Office on 0117 907 0020 if you wish to arrange a viewing appointment for this property or require further information.

These particulars, whilst believed to be accurate are set out as a general outline only for guidance and do not constitute any part of an offer or contract. Intending purchasers should not rely on them as statements of representation of fact, but must satisfy themselves by inspection or otherwise as to their accuracy. No person in this firms employment has the authority to make or give any representation or warranty in respect of the property.

Energy Efficiency Graph

