

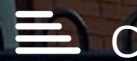

Flat 7, Barrington Court Winton Street  
Totterdown, Bristol, BS4 2BT

Asking price **£219,000**

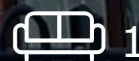

# Flat 7, Barrington Court Winton Street



## Description

Situated just off the Wells Road is this top floor flat with far reaching views of Bristol! Comprising lounge with box bay window, separate kitchen, master bedrooms with fitted wardrobes and a small single with built in cupboards.

The bathroom has a shower over the bath. Ideal for those looking to be close to Temple Meads, the City and looking to make their own style. Further benefits include allocated parking and no onward chain.

955 Years left on lease. £20 Ground Rent PA. Service Charge £700 pa  
Council Tax Band - Band B (Bristol City)

- TOP FLOOR APARTMENT
- LOUNGE
- TWO BEDROOMS
- BATHROOM
- LOVELY VIEWS
- KITCHEN
- CLOSE TO TEMPLE MEADS
- ALLOCATED PARKING





## Floor Plan

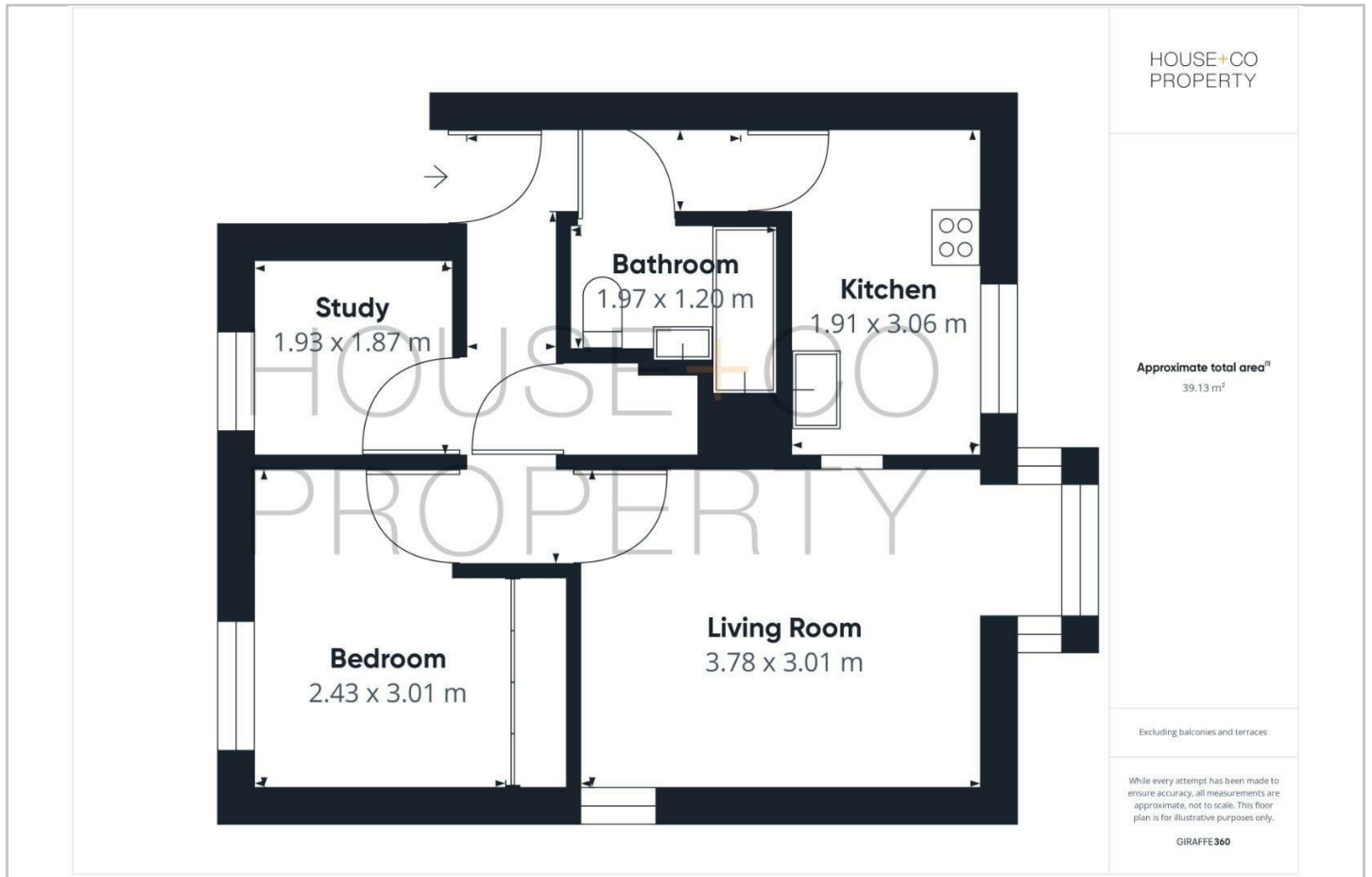

## Area Map

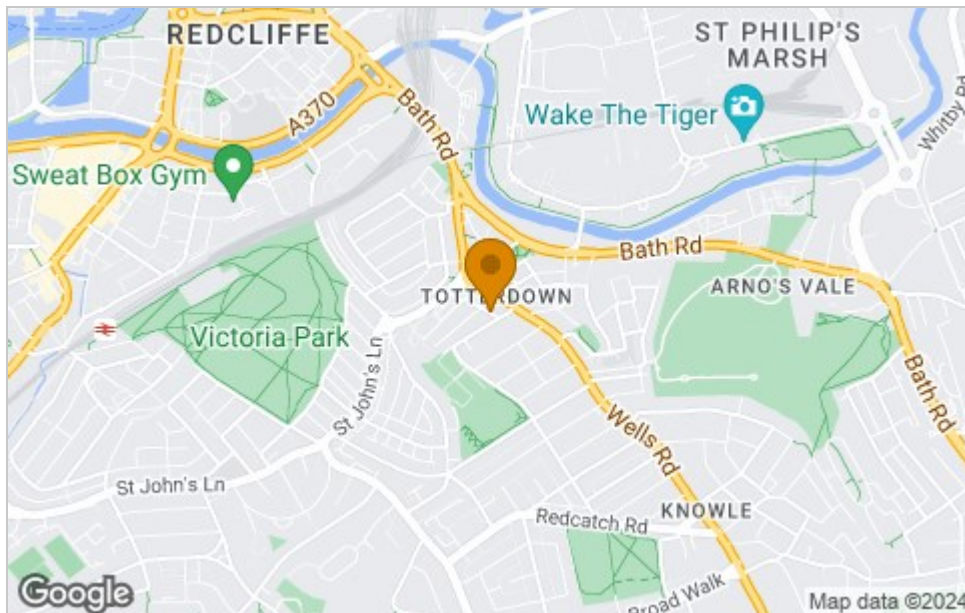

## Viewing

Please contact our House + Co Property (Sales) Office on 0117 907 0020 if you wish to arrange a viewing appointment for this property or require further information.

## Energy Efficiency Graph

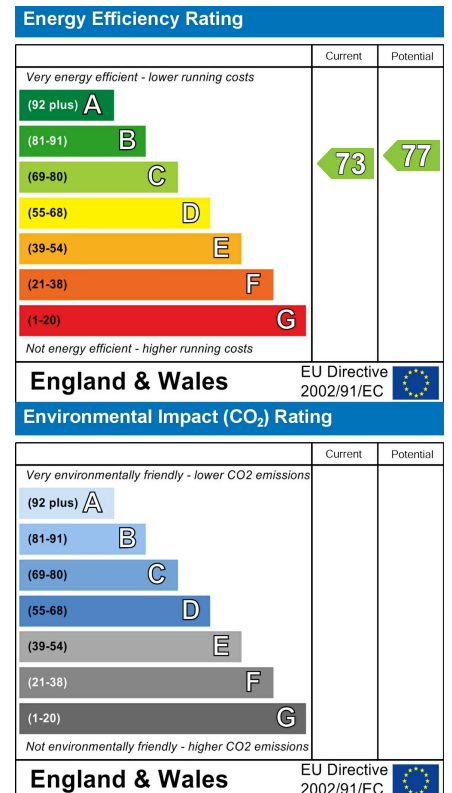

These particulars, whilst believed to be accurate are set out as a general outline only for guidance and do not constitute any part of an offer or contract. Intending purchasers should not rely on them as statements of representation of fact, but must satisfy themselves by inspection or otherwise as to their accuracy. No person in this firm's employment has the authority to make or give any representation or warranty in respect of the property.