



Howard Morley
& Sons

PCM

£2,400 PCM

Artillery Road

Guildford, GU1 4NN



Artillery Road, Guildford

Approximate Gross Internal Area
Lower Ground Floor = 19.1 sq m / 206 sq ft
Ground Floor = 50.4 sq m / 543 sq ft
First Floor = 40.4 sq m / 435 sq ft
Second Floor (Excluding Eaves / Reduced Headroom)
= 14.6 sq m / 157 sq ft
Total = 124.5 sq m / 1341 sq ft

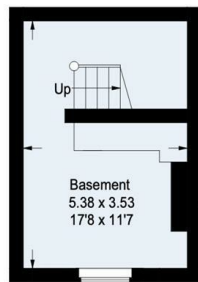

Lower Ground Floor

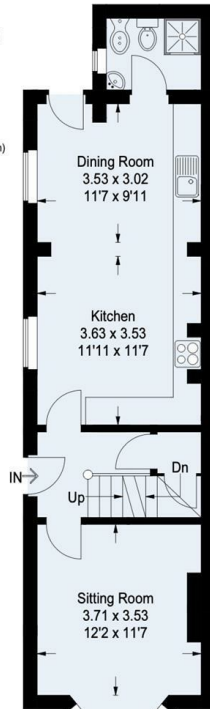

Ground Floor

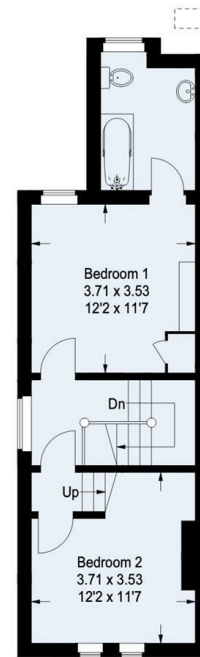

First Floor

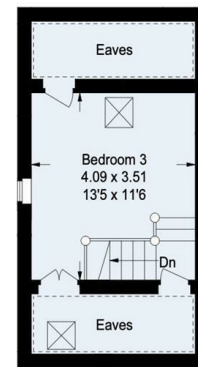

Second Floor

This plan is for representation purposes only. Reproduced from plans supplied by the Agent. Not drawn to scale unless stated. Please check all dimensions before making any decisions reliant upon them. No guarantee is given on square footage if quoted. Any figures if quoted should not be used as a basis for valuation.

3

2

2

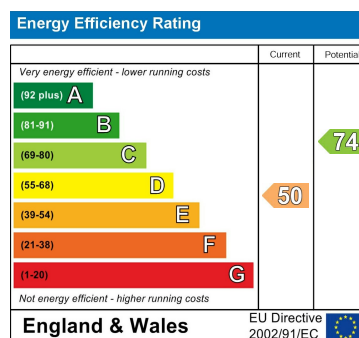

Agents Note: Whilst every care has been taken to prepare these particulars, they are for guidance purposes only. All measurements are approximate and are for general guidance purposes only and whilst every care has been taken to ensure their accuracy, they should not be relied upon and potential buyers/tenants are advised to recheck the measurements

Howard Morley
& Sons

OFFICE ADDRESS
276 High Street
Guildford
Surrey
GU1 3JL

OFFICE DETAILS
01483 575 304
lettings@hmorley.co.uk
hmorley.co.uk