

The logo for Howard Morley & Sons is positioned in the top right corner of the image. It features the company name in a dark, elegant serif font, with a stylized ampersand between the words. The background of the entire image is a photograph of a single-story white brick building with a dark blue roof and a large section of orange and brown patterned tiles. A blue door and windows are visible on the building's facade.

Howard Morley
& Sons

£1,250

Vann Lane

Godalming, GU8 4DY



Approximate Gross Internal Area
63.06 sq m / 678.77 sq ft

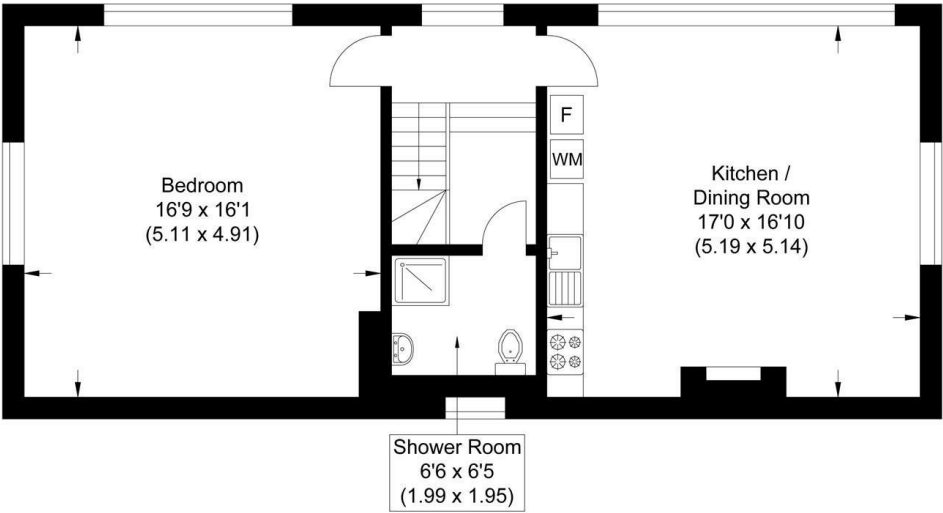

Illustration for identification purposes only, measurements are approximate, not to scale.

1

1

1

Energy Efficiency Rating		
	Current	Potential
Very energy efficient - lower running costs		
(92 plus) A		
(81-91) B		
(69-80) C		
(55-68) D		
(39-54) E		
(21-38) F		
(1-20) G		
Not energy efficient - higher running costs		
England & Wales		EU Directive 2002/91/EC

Agents Note: Whilst every care has been taken to prepare these particulars, they are for guidance purposes only. All measurements are approximate and are for general guidance purposes only and whilst every care has been taken to ensure their accuracy, they should not be relied upon and potential buyers/tenants are advised to recheck the measurements

Howard Morley

& Sons

OFFICE ADDRESS

276 High Street

Guildford

Surrey

GU1 3JL

OFFICE DETAILS

01483 575 304

lettings@hmorley.co.uk

hmorley.co.uk