

Howard Morley & Sons

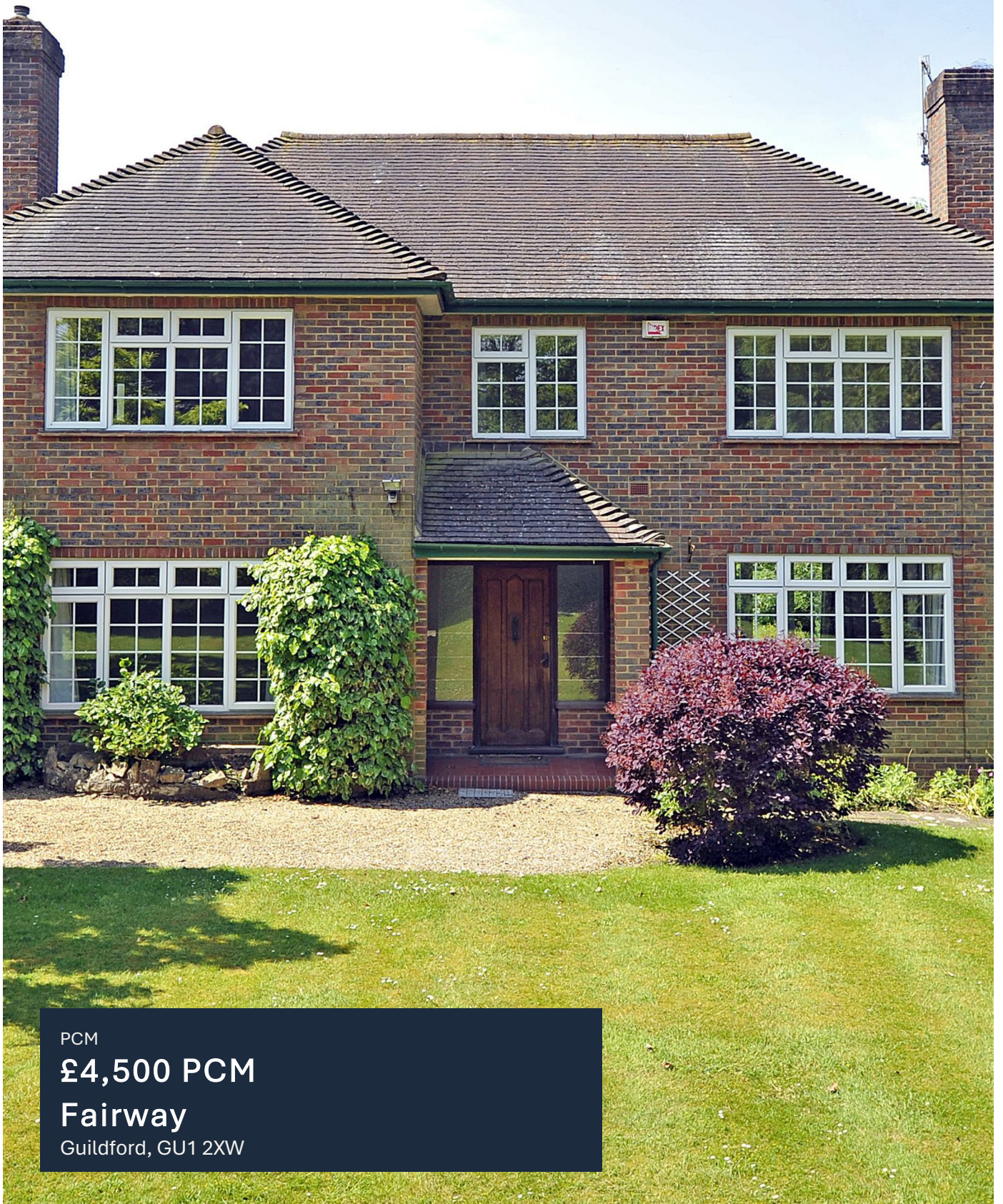

PCM

£4,500 PCM

Fairway

Guildford, GU1 2XW



Fairway, Merrow

Approximate Gross Internal Area
Ground Floor = 87.4 sq m / 941 sq ft
First Floor = 76 sq m / 818 sq ft
Garage / VWC = 29.5 sq m / 317 sq ft
Total = 192.9 sq m / 2076 sq ft

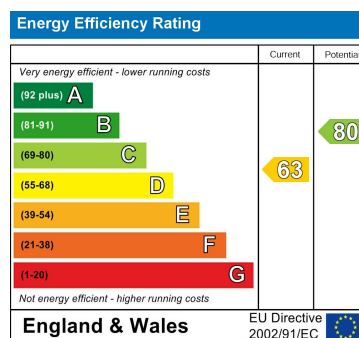
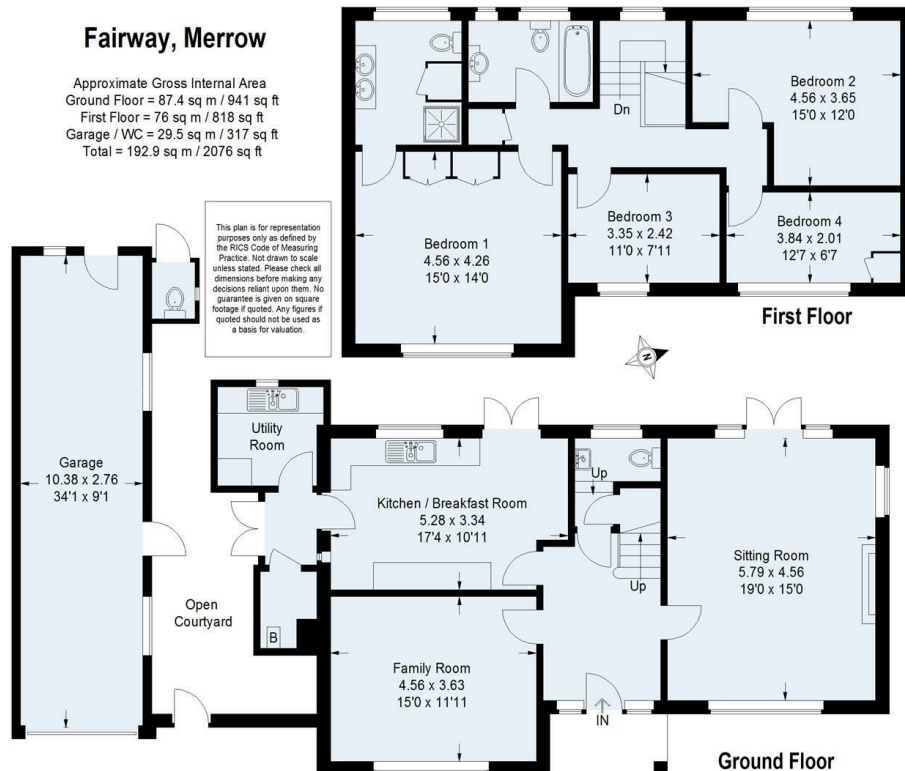

Agents Note: Whilst every care has been taken to prepare these particulars, they are for guidance purposes only. All measurements are approximate and are for general guidance purposes only and whilst every care has been taken to ensure their accuracy, they should not be relied upon and potential buyers/tenants are advised to recheck the measurements

Howard Morley
& Sons

OFFICE ADDRESS
276 High Street
Guildford
Surrey
GU1 3JL

OFFICE DETAILS
01483 575 304
lettings@hmorley.co.uk
hmorley.co.uk