



Howard Morley  
& Sons

PER MONTH

**£8,950 Per Month**  
**Norley Lane**



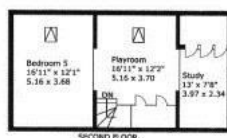

Approximate gross internal area:  
House: 275 sq m / 2960 sq ft  
Office: 14 sq m / 150 sq ft  
TOTAL: 289 sq m / 3110 sq ft

This drawing is in accordance with  
PAS 98 guidelines. It is not to scale and  
is for illustration purposes only 2013

5



4



3



Agents Note: Whilst every care has been taken to prepare these particulars, they are for guidance purposes only. All measurements are approximate and are for general guidance purposes only and whilst every care has been taken to ensure their accuracy, they should not be relied upon and potential buyers/tenants are advised to recheck the measurements

#### Energy Efficiency Rating

	Current	Potential
Very energy efficient - lower running costs		
(92 plus) <b>A</b>		
(81-91) <b>B</b>		
(69-80) <b>C</b>		
(55-68) <b>D</b>		
(39-54) <b>E</b>		
(21-38) <b>F</b>		
(1-20) <b>G</b>		
Not energy efficient - higher running costs		
<b>England &amp; Wales</b>	EU Directive 2002/91/EC	

Howard Morley  
& Sons

**OFFICE ADDRESS**  
276 High Street  
Guildford  
Surrey  
GU1 3JL

**OFFICE DETAILS**  
01483 575 304  
lettings@hmorley.co.uk  
hmorley.co.uk