



Market Street, Cinderford, GL14 2RT
£895 Per Month





£895 Per Month

Market Street

Cinderford, GL14 2RT

- NEWLY BUILT FLAT
- TWO BEDROOMS
- SHOWER ROOM
- DOUBLE GLAZING
- TOWN CENTRE LOCATION
- ENTRANCE HALL
- OPEN PLAN KITCHEN / LOUNGE
- GAS CENTRAL HEATING
- INTERCOM SYSTEM

Newly built two bedroom, second floor apartment in Cinderford town centre. Intercom system, bike store.

The property benefits from entrance hall, two bedrooms, open plan kitchen / lounge, shower room, gas central heating and double glazing.

The Forest of Dean: You will find nature on your doorstep when you move to the forest of dean. With its many attractions, cycle tracks, caves and museums, steam railways, nature reserves, lakes, and picnic area's. A rich heritage and a landscape ripe for exploring and getting off the beaten track. This brochure is a guide to each of the apartments for sale, floorplans and virtual tours are available on our website, www.deanestateagents.co.uk

Some of the images used within our marketing are computer generated and may not represent the property on completion.



Entrance Lobby :

Entrance Hall : 3'2" x 15'8" (0.99 x 4.80)

Bedroom One : 15'10" x 9'5" (4.84 x 2.88)

Bedroom Two : 15'11" x 7'11" (4.86 x 2.42)

Open Plan Kitchen / Lounge : 15'11" x 11'0" (4.87 x 3.37)

Shower Room : 8'7" x 5'3" (2.63 x 1.62)





Directions

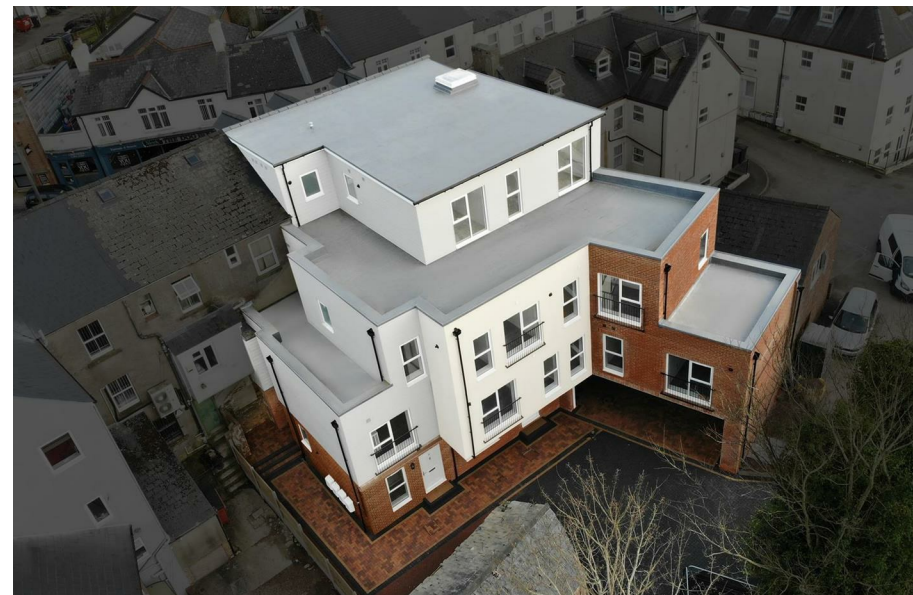

Floor Plans

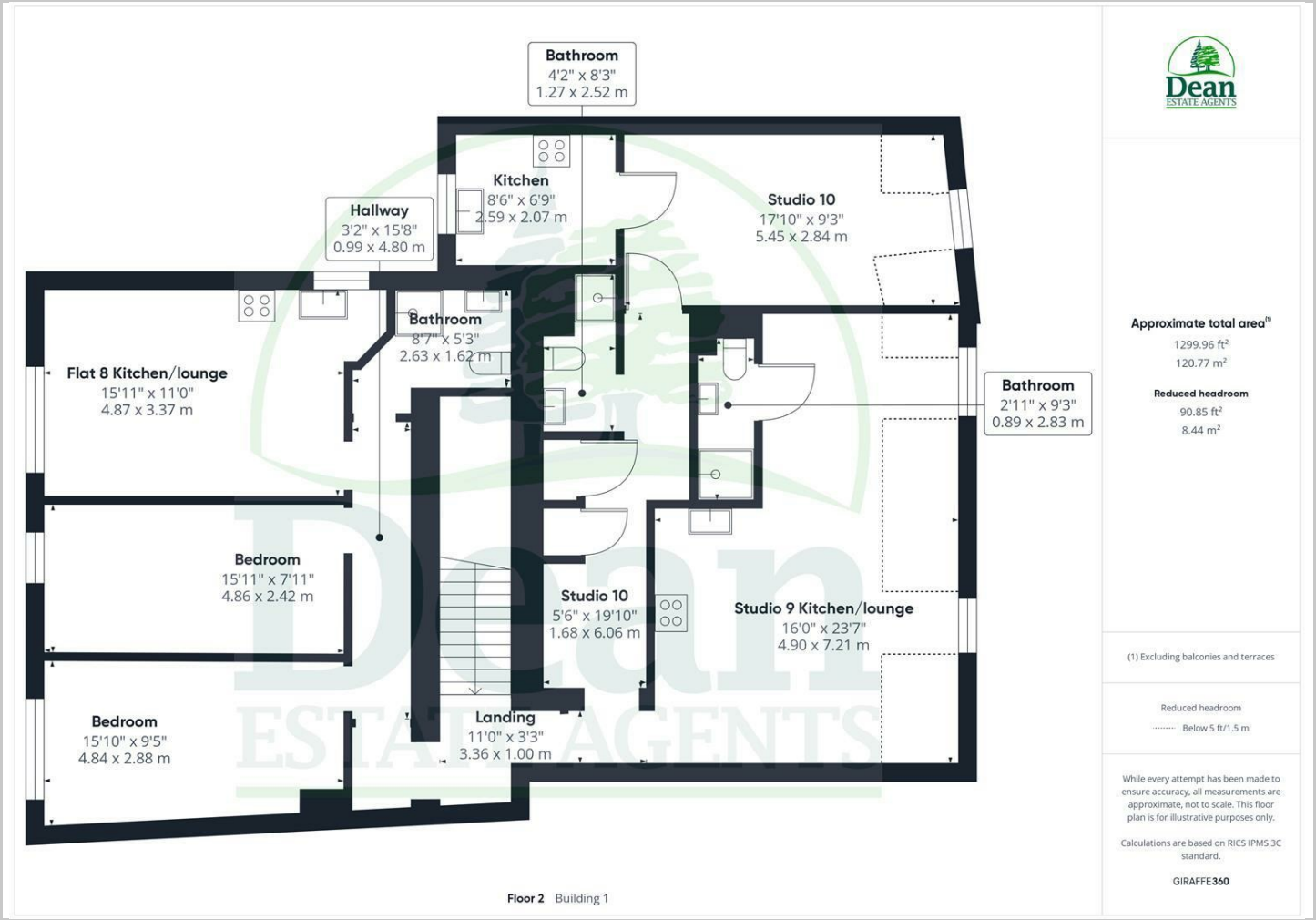

Viewing

Please contact our Coleford Office on 01594 835751 if you wish to arrange a viewing appointment for this property or require further information.

The particulars are set out as a general outline only for the guidance of intended purchasers or lessees, and do not constitute, any part of a contract. Nothing in these particulars shall be deemed to be a statement that the property is in good structural condition or otherwise nor that any of the services, appliances, equipment or facilities are in good working order. Purchasers should satisfy themselves of this prior to purchasing.

14 St John Street, Coleford, Gloucestershire, GL16 8AR
Tel: 01594 835751 Email: coleford@deanestateagents.co.uk www.deanestateagents.co.uk

Location Map

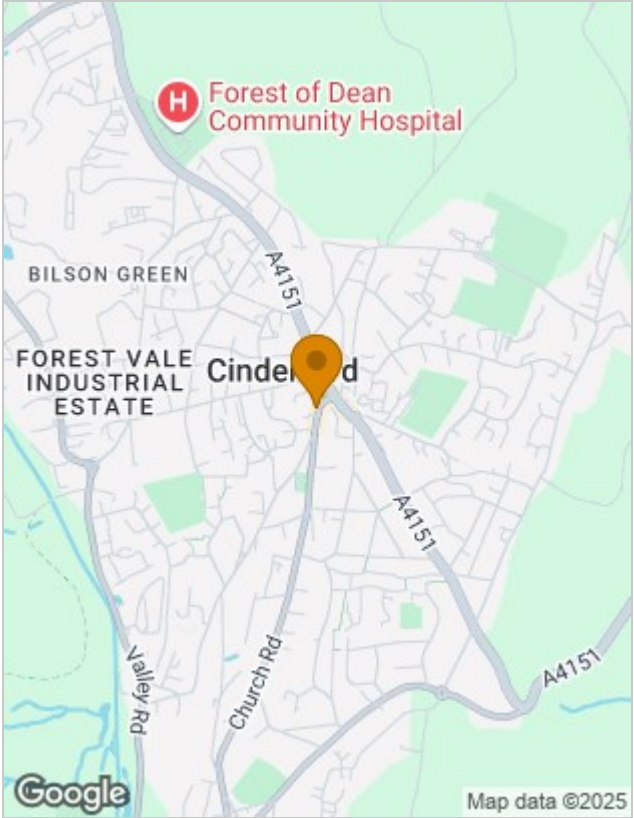

Energy Performance Graph

