



HUNTERS[®]
HERE TO GET *you* THERE

2 Olivet Road, Woodseats, Sheffield, S8 8QS

2 Olivet Road, Woodseats, Sheffield, S8 8QS

£240,000

Welcome to this charming property located on Olivet Road in the heart of Woodseats. This delightful end terrace house boasts four bedrooms, making it perfect for a growing family or those in need of extra space.

As you step inside, you'll be greeted by a modern kitchen that is sure to inspire your inner chef. The four-piece bathroom offers both style and functionality, providing a relaxing space to unwind after a long day.

Situated in the central Woodseats location, you'll have easy access to a range of amenities, including shops, schools, and parks, making it a convenient choice for daily living.

One of the highlights of this property is the level end terrace garden, complete with a lawn and a decked area, perfect for enjoying a morning coffee or hosting summer barbecues with friends and family.

What's more, this property comes with no onward chain, ensuring a smooth and hassle-free buying process. Don't miss out on the opportunity to make this house your home. Contact us today to arrange a viewing and start envisioning your future in this wonderful property on Olivet Road.

GENERAL REMARKS

TENURE

This property is Freehold.

RATING ASSESSMENT

We are verbally advised by the Local Authority that the property is assessed for Council Tax purposes to Band A.

VACANT POSSESSION

Vacant possession will be given on completion and all fixtures and fittings mentioned in the above particulars are to be included in the sale.

MORTGAGE FACILITIES

We should be pleased to advise you in obtaining the best type of Mortgage to suit your individual requirements. **YOUR HOME IS AT RISK IF YOU DO NOT KEEP UP REPAYMENTS ON A MORTGAGE OR OTHER LOANS SECURED ON IT.**

Hunters Sheffield - Woodseats 764 Chesterfield Road, Woodseats, S8 0SE | 0114 258 0111
sheffieldwoodseats@hunters.com | www.hunters.com

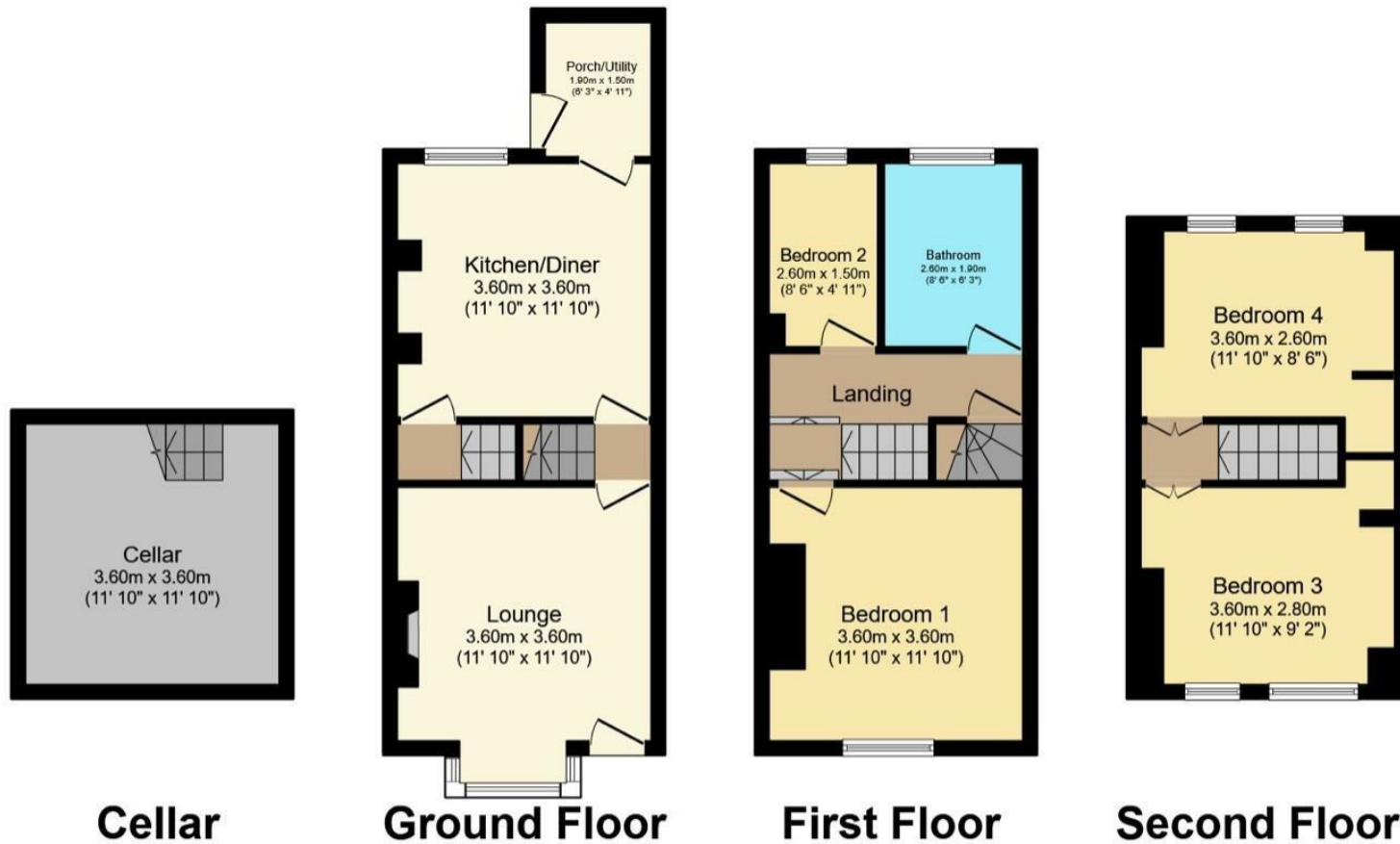

Total floor area 99.5 m² (1,071 sq.ft.) approx

This floor plan is for illustrative purposes only. It is not drawn to scale. Any measurements, floor areas (including any total floor area), openings and orientation are approximate. No details are guaranteed, they cannot be relied upon for any purpose and they do not form part of any agreement. No liability is taken for any error, omission or misstatement. A party must rely upon its own inspection(s).

Powered by www.focalagent.com

| Energy Efficiency Rating | | Current | Potential |
|---|--|-------------------------|-----------|
| Very energy efficient - lower running costs | | | |
| (92 plus) A | | | |
| (81-91) B | | | |
| (69-80) C | | | |
| (55-68) D | | | |
| (39-54) E | | | |
| (21-38) F | | | |
| (1-20) G | | | |
| Not energy efficient - higher running costs | | | |
| | | 57 | 84 |
| England & Wales | | EU Directive 2002/91/EC | |

| Environmental Impact (CO ₂) Rating | | Current | Potential |
|---|--|-------------------------|-----------|
| Very environmentally friendly - lower CO ₂ emissions | | | |
| (92 plus) A | | | |
| (81-91) B | | | |
| (69-80) C | | | |
| (55-68) D | | | |
| (39-54) E | | | |
| (21-38) F | | | |
| (1-20) G | | | |
| Not environmentally friendly - higher CO ₂ emissions | | | |
| England & Wales | | EU Directive 2002/91/EC | |

Energy Efficiency Rating

| | Current | Potential |
|--|----------------------------|---|
| <i>Very energy efficient - lower running costs</i> | | |
| (92 plus) A | | |
| (81-91) B | | 84 |
| (69-80) C | | |
| (55-68) D | 57 | |
| (39-54) E | | |
| (21-38) F | | |
| (1-20) G | | |
| <i>Not energy efficient - higher running costs</i> | | |
| England & Wales | EU Directive 2002/91/EC |  |

These particulars are intended to give a fair and reliable description of the property but no responsibility for any inaccuracy or error can be accepted and do not constitute an offer or contract. We have not tested any services or appliances (including central heating if fitted) referred to in these particulars and the purchasers are advised to satisfy themselves as to the working order and condition. If a property is unoccupied at any time there may be reconnection charges for any switched off/disconnected or drained services or appliances - All measurements are approximate. If you are thinking of selling your home or just curious to discover the value of your property, Hunters would be pleased to provide free, no obligation sales and marketing advice. Even if your home is outside the area covered by our local offices we can arrange a Market Appraisal through our national network of Hunters estate agents.



