



**HUNTERS**<sup>®</sup>  
HERE TO GET *you* THERE

61 Mitchell Road, Woodseats, Sheffield, S8 0GR

# 61 Mitchell Road, Woodseats, Sheffield, S8 0GR

## Asking Price £250,000

A two/three bedroom semi detached house located in the popular and sought after area of Woodseats close to Abbeydale Road and Chesterfield Road. The property which is situated on a level road briefly comprises; side entrance lobby with stairs to the first floor, front living room and a rear dining kitchen having matching wall and base units together with stairs down to a cellar in the basement currently used as a workshop. To the first floor is the landing, two bedrooms and a w.c. Stairs from the landing lead to a second floor occasional bedroom and bathroom. There is eaves access from the bathroom.

Externally the property is set back from the road and has a small fore-garden whilst to the rear is a private and enclosed two tiered garden. The rear has a brick built outbuilding providing useful storage with the lower level patio making an ideal space for alfresco dining, there are steps then up to the upper level which is mainly laid to lawn.

### GENERAL REMARKS

#### TENURE

This property is Freehold.

#### RATING ASSESSMENT

We are verbally advised by the Local Authority that the property is assessed for Council Tax purposes to Band B.

#### VACANT POSSESSION

Vacant possession will be given on completion and all fixtures and fittings mentioned in the above particulars are to be included in the sale.

#### MORTGAGE FACILITIES

We should be pleased to advise you in obtaining the best type of Mortgage to suit your individual requirements.

**YOUR HOME IS AT RISK IF YOU DO NOT KEEP UP REPAYMENTS ON A MORTGAGE OR OTHER LOANS SECURED ON IT.**

Hunters Sheffield - Woodseats 764 Chesterfield Road, Woodseats, S8 0SE | 0114 258 0111  
sheffieldwoodseats@hunters.com | www.hunters.com

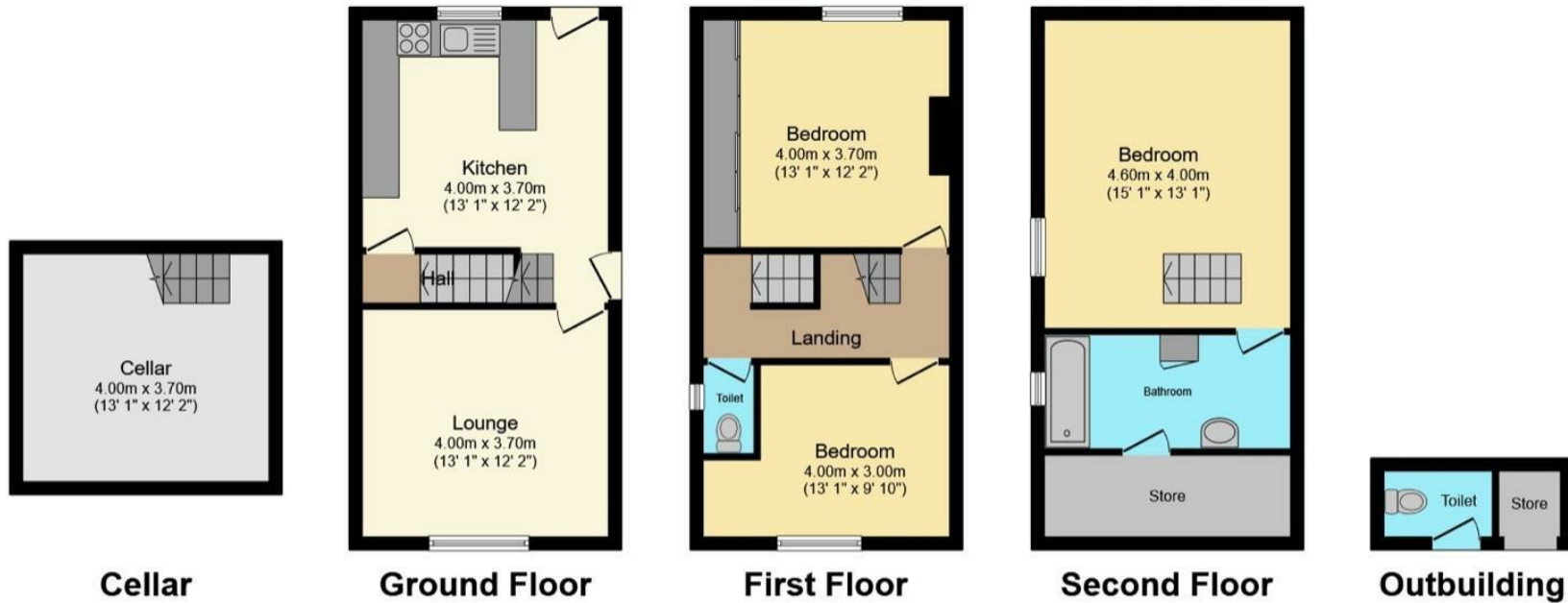

Total floor area 118.7 m<sup>2</sup> (1,277 sq.ft.) approx

This floor plan is for illustrative purposes only. It is not drawn to scale. Any measurements, floor areas (including any total floor area), openings and orientation are approximate. No details are guaranteed, they cannot be relied upon for any purpose and they do not form part of any agreement. No liability is taken for any error, omission or misstatement. A party must rely upon its own inspection(s).

Powered by [www.focalagent.com](http://www.focalagent.com)

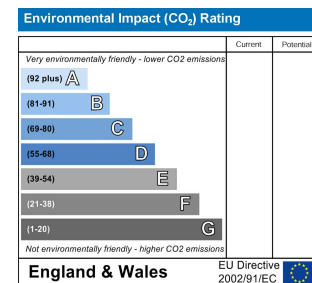
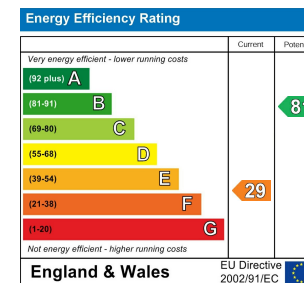

## Energy Efficiency Rating

	Current	Potential
<i>Very energy efficient - lower running costs</i>		
(92 plus) <b>A</b>		
(81-91) <b>B</b>		<b>81</b>
(69-80) <b>C</b>		
(55-68) <b>D</b>		
(39-54) <b>E</b>	<b>29</b>	
(21-38) <b>F</b>		
(1-20) <b>G</b>		
<i>Not energy efficient - higher running costs</i>		
<b>England &amp; Wales</b>	EU Directive 2002/91/EC	

These particulars are intended to give a fair and reliable description of the property but no responsibility for any inaccuracy or error can be accepted and do not constitute an offer or contract. We have not tested any services or appliances (including central heating if fitted) referred to in these particulars and the purchasers are advised to satisfy themselves as to the working order and condition. If a property is unoccupied at any time there may be reconnection charges for any switched off/disconnected or drained services or appliances - All measurements are approximate. If you are thinking of selling your home or just curious to discover the value of your property, Hunters would be pleased to provide free, no obligation sales and marketing advice. Even if your home is outside the area covered by our local offices we can arrange a Market Appraisal through our national network of Hunters estate agents.







