



17 Beacon Park Road, Upton, Poole, BH16 5NZ

Asking Price £349,950

- Detached Bungalow
- Extended Accommodation
- Southerly Aspect Garden
- Gas Central Heating
- Favoured Location
- Three Bedrooms
- Garage & Driveway
- Spacious Throughout
- Close to Bus Routes & Schooling
- No Forward Chain

17 Beacon Park Road, Poole BH16 5NZ

A spacious, extended bungalow situated within the ever popular 'Beacon Park Development' of Upton. With a south facing garden & large driveway.



Council Tax Band: D



Beacon Park Road

Whilst requiring a certain degree of updating, this property offers a great opportunity to put your own stamp on an already spacious home.

Briefly, the extended accommodation comprises three bedrooms, kitchen, extended lounge/dining room, shower room and separate toilet.

Further benefits include a south facing rear garden, garage, UPVC glazing and gas central heating.

Situated within the ever popular 'Beacon Park' development on the west side of Upton, the property is ideally located close to local shops, bus routes and popular local schools.

Offered for sale with no onward chain, internal viewing is encouraged at your earliest convenience. To arrange, or for more information, please contact our Upton Office.

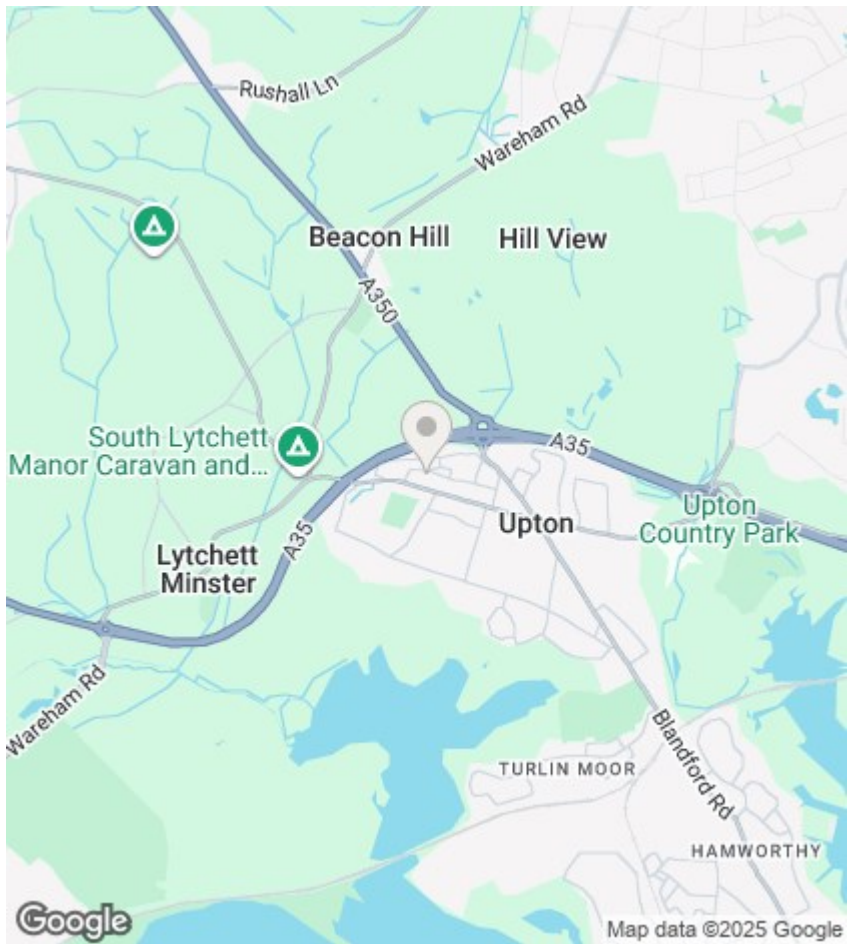

Agents Note

Whilst every attempt has been made to ensure the accuracy of details and measurements contained in these particulars, they are not to be relied upon especially when potential cost could be incurred.
 No appliances have been tested so the agent cannot verify that they are in working order.
 The agent has not seen any legal documentation to verify the legal status of the property. This must be verified by your chosen solicitor.

Viewings

Viewings by arrangement only. Call 01202 622101 to make an appointment.

EPC Rating:

D

Energy Efficiency Rating		
	Current	Potential
Very energy efficient - lower running costs		
(92 plus) A		
(81-91) B		
(69-80) C		
(55-68) D	59	71
(39-54) E		
(21-38) F		
(1-20) G		
Not energy efficient - higher running costs		
England & Wales	EU Directive 2002/91/EC	

Beacon Park Road, Upton

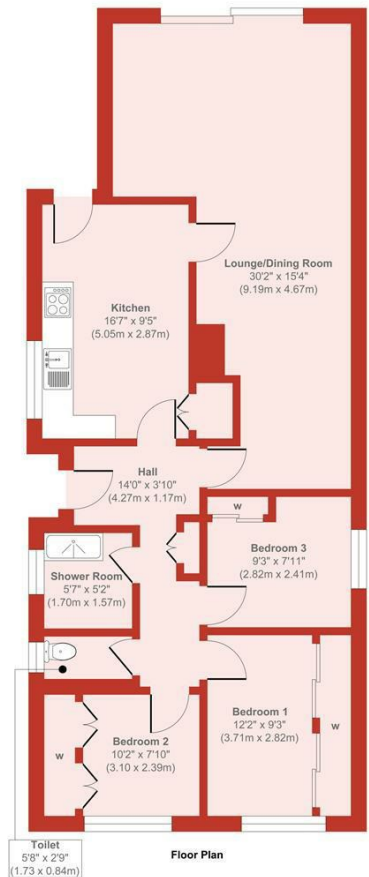

Approx. Gross Internal Floor Area 947 sq. ft / 87.97 sq. m
 Produced by Elements Property