

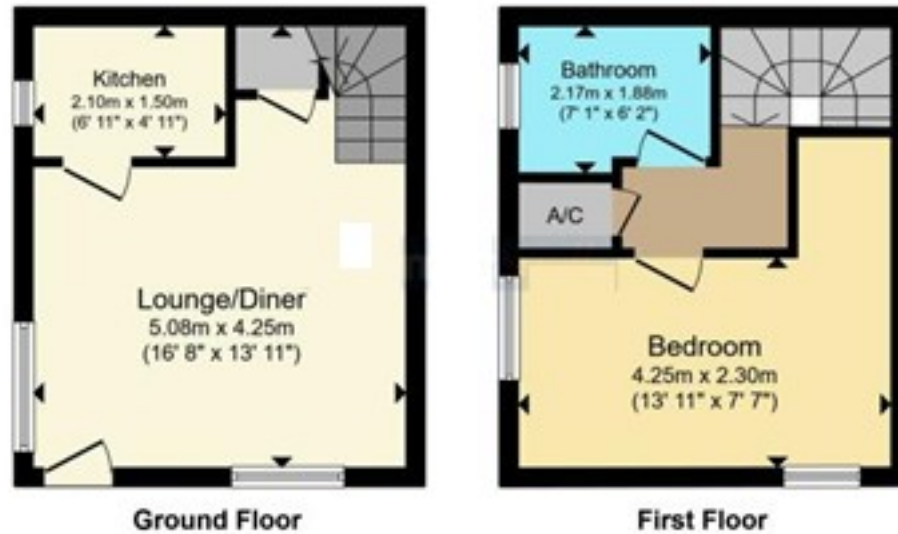

159 Meadowsweet Road, Creekmoor, Poole, BH17 7XY

£950 PCM

- One Double Bedroom
- Popular Location
- Allocated Parking
- Viewings Recommended
- Cluster House
- Private Enclosed Garden
- Useful Storage
- Available Mid August
- Close To Local Amenities
- UPVC Double Glazing



Total floor area 42.8 sq.m. (460 sq.ft.) approx

This floorplan is for illustrative purposes only and is not drawn to scale. Measurements, floor-areas, openings and orientations are approximate. They should not be relied upon for any purpose and do not form any part of an agreement. No liability is taken for any error or mis-statement. All parties must rely on their own inspections.

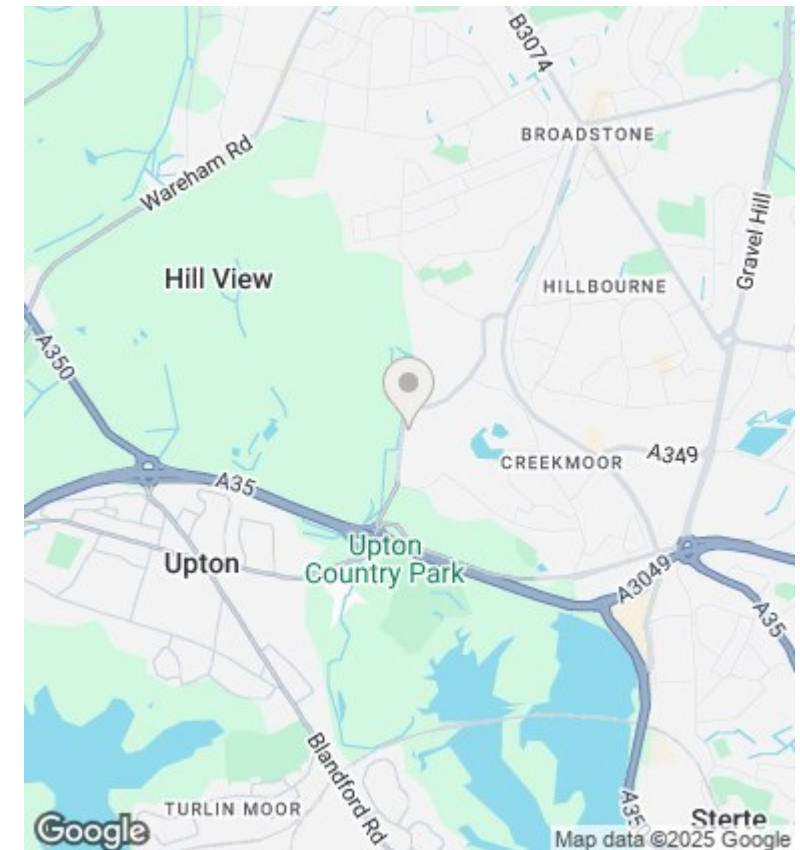

Directions

Viewings

Viewings by arrangement only. Call 01202 622101 to make an appointment.

Council Tax Band

B

EPC Rating:

E

Energy Efficiency Rating		
	Current	Potential
Very energy efficient - lower running costs		
(92-plus) A		94
(81-91) B		
(69-80) C		
(55-68) D		
(39-54) E	43	
(21-38) F		
(1-20) G		
Not energy efficient - higher running costs		
England & Wales		EU Directive 2002/91/EC