

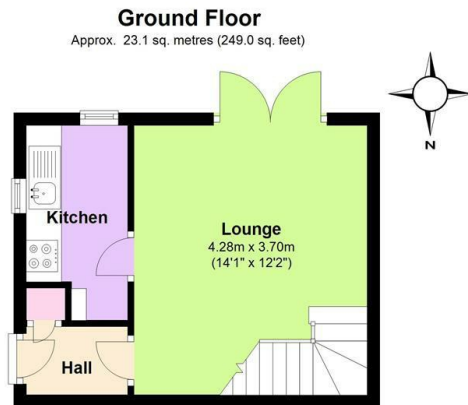

27 Larch Close, Creekmoor, Poole, Dorset, BH17 7YL

£1,195 Per Calendar Month

- Two Bedrooms
- Modern Open-Plan Living
- GCH/UPVC Double Glazing
- Available Now
- Cluster House
- Private Rear Garden
- Unfurnished
- Recently Refurbished
- Allocated Parking
- Popular Location



Total area: approx. 46.3 sq. metres (498.0 sq. feet)

Bournemouth Energy Floor Plans are provided for illustration/identification purposes only. Not drawn to scale, unless stated and accept no responsibility for any error, omission or mis-statement. Dimensions shown are to the nearest 7.5 cm / 3 inches. Total approx area shown on the plan may include any external terraces, balconies and other external areas. To find out more about Bournemouth Energy please visit www.bournemouthenergy.co.uk (Tel: 01202 556006)
Plan produced using PlanUp.

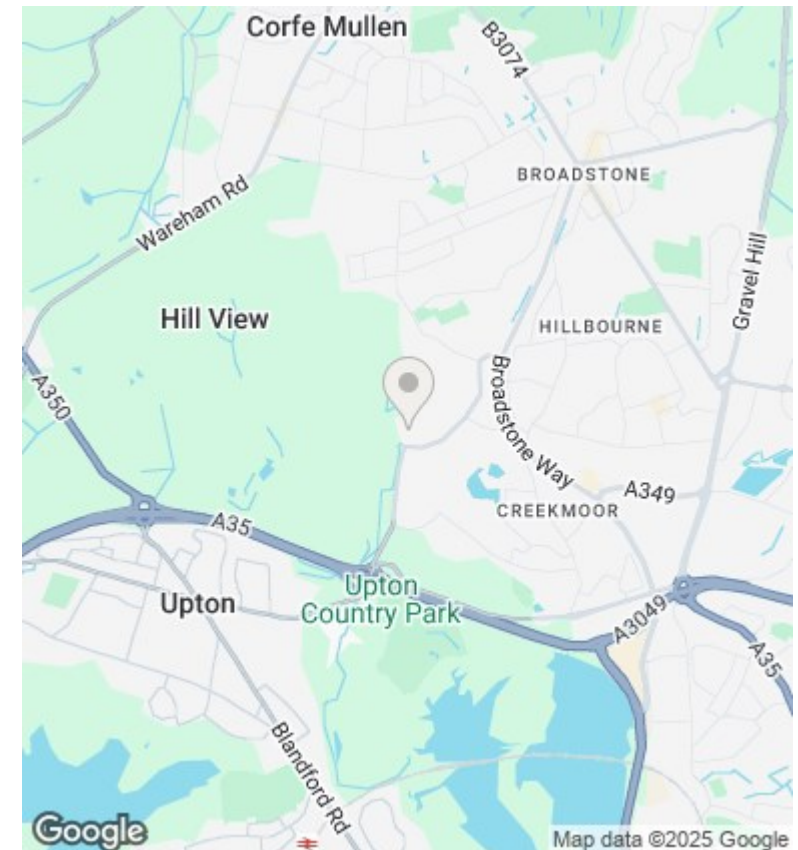

Directions

Viewings

Viewings by arrangement only. Call 01202 622101 to make an appointment.

Council Tax Band

B

EPC Rating:

C

Energy Efficiency Rating		
	Current	Potential
Very energy efficient - lower running costs		
(92 plus) A		89
(81-91) B	73	
(69-80) C		
(55-68) D		
(39-54) E		
(21-38) F		
(1-20) G		
Not energy efficient - higher running costs		
England & Wales	EU Directive 2002/91/EC	