



91 Hewitt Road, Hamworthy, Poole, Dorset, BH15 4QD

Asking Price £265,000

- Two Double Bedrooms
- Off-Road Parking
- Cul-De-Sac Location
- Gas Central Heating
- Modern Double Glazing
- End of Terrace House
- Garage in a Block
- Ideal First Time Buy
- Low Maintenance Rear Garden
- No Forward Chain!

91 Hewitt Road, Poole BH15 4QD

Offered for sale with NO FORWARD CHAIN is this neutrally presented end of terrace house situated within the popular 'Cobbs Quay' development.



Council Tax Band: B



Hewitt Road

The property briefly comprises two double bedrooms, sizeable lounge/dining room, bathroom and kitchen leading out to a low maintenance rear garden.

Further benefits include off road parking, gas central heating, modern UPVC double glazing, a garage in a block and an enviable position within walking distance from Cobbs Quay.

The property is offered for sale with no forward chain and we believe will make an ideal first time buy, therefore we encourage viewing at your earliest convenience. To arrange, or for more information, please call our Upton office.



Agents Note

Whilst every attempt has been made to ensure the accuracy of details and measurements contained in these particulars, they are not to be relied upon especially when potential cost could be incurred. No appliances have been tested so the agent cannot verify that they are in working order. The agent has not seen any legal documentation to verify the legal status of the property. This must be verified by your chosen solicitor.

Viewings

Viewings by arrangement only. Call 01202 622101 to make an appointment.

EPC Rating:

Energy Efficiency Rating		Current	Potential
Very energy efficient - lower running costs			
(92 plus) A			
(81-91) B			
(69-80) C			
(55-68) D			
(39-54) E			
(21-38) F			
(1-20) G			
Not energy efficient - higher running costs			
England & Wales		EU Directive 2002/91/EC	

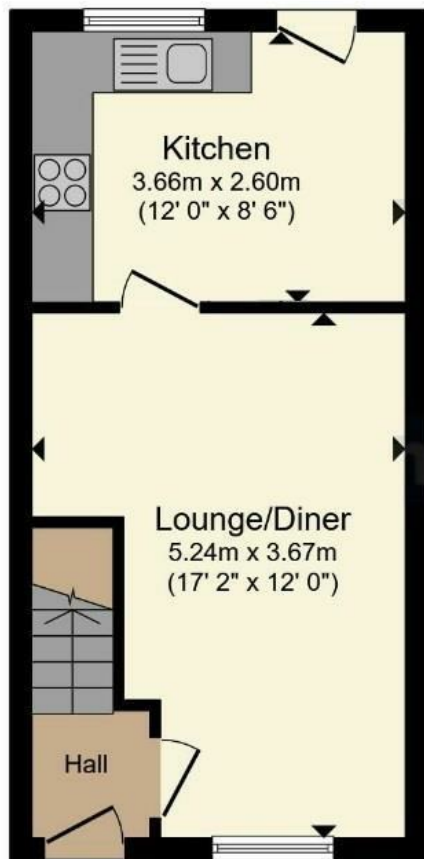

Ground Floor

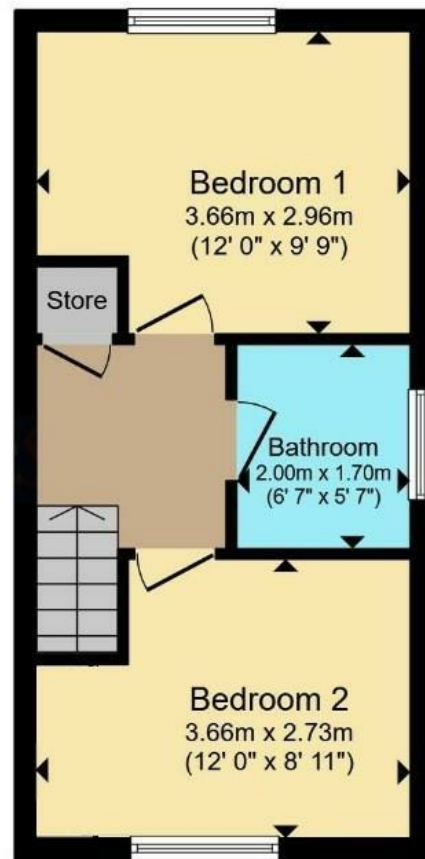

First Floor