

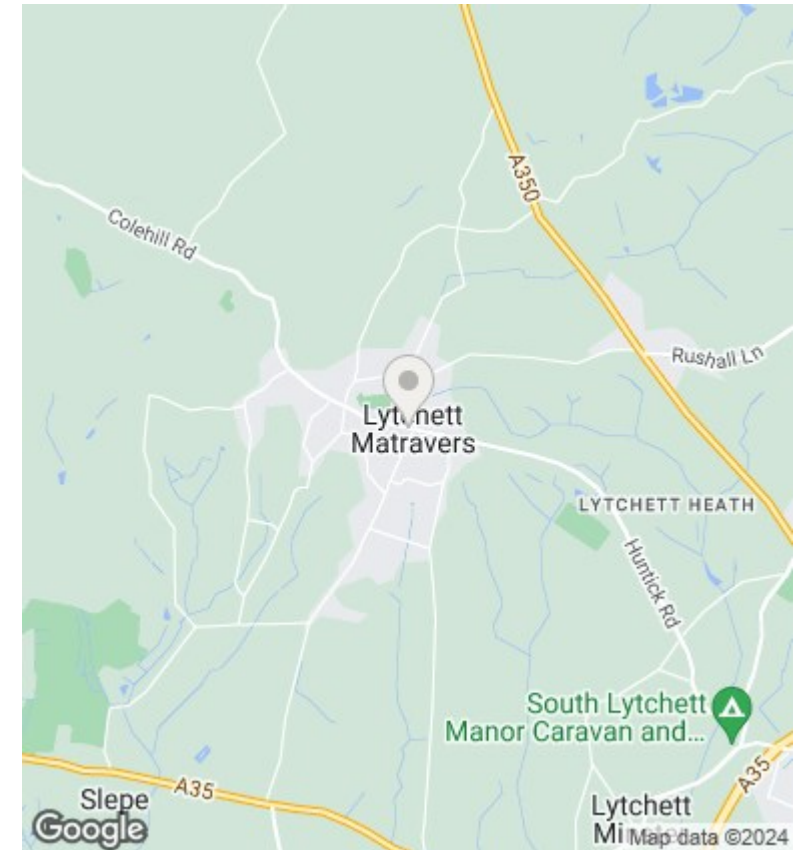

## 5 High Street, Lytchett Matravers, Poole, BH16 6BG

£1,495 Per Calendar Month

- Three Bedrooms
- GCH / Double Glazing
- Popular Residential Location
- Available Now!
- Semi Detached House
- Close to Village Amenities
- Long Term
- Spacious Throughout
- Southerly Rear Garden
- Unfurnished

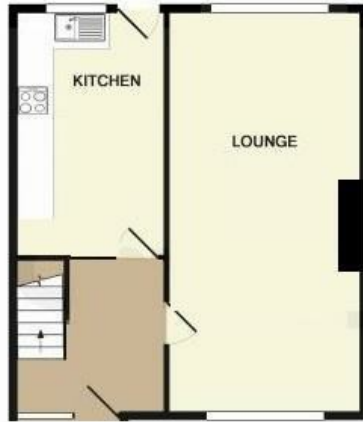

## Directions

## Viewings

Viewings by arrangement only. Call 01202 622101 to make an appointment.

## Council Tax Band

C

## EPC Rating:

D

Energy Efficiency Rating		Current	Potential
<i>Very energy efficient - lower running costs</i>			
(92 plus)	A		
(81-91)	B		83
(69-80)	C		
(55-68)	D	62	
(39-54)	E		
(21-38)	F		
(1-20)	G		
<i>Not energy efficient - higher running costs</i>			
<b>England &amp; Wales</b>		EU Directive 2002/91/EC	