



HUNTERS[®]
HERE TO GET *you* THERE

22 Cardigan House Adelaide Lane, Kelham Island, Sheffield,
S3 8BR

22 Cardigan House Adelaide Lane, Kelham Island, Sheffield, S3 8BR

£110,000

Welcome to Cardigan House, Sheffield - a charming location in the heart of the highly sought-after Kelham Island area. This delightful one-bedroom first-floor purpose-built apartment is a gem waiting to be discovered.

As you step into this property, you are greeted by a cosy reception room that offers a perfect space to relax and unwind. The bedroom is spacious and provides a peaceful retreat after a long day. The bathroom is modern and well-maintained, offering both style and functionality.

Built in 2007, this flat boasts a contemporary feel while being situated in a vibrant and historic area. Kelham Island is renowned for its trendy cafes, restaurants, and proximity to the picturesque River Don, making it a desirable location for those seeking a blend of urban living and natural beauty.

Whether you are looking for a place to call home or considering an investment opportunity, this property offers great rental potential. With no onward chain, the process of making this apartment your own is made even smoother.

GENERAL REMARKS

TENURE

This property is long Leasehold with a term of 197 years from 19th December 2007 at a ground rent of £100 per annum.

SERVICE CHARGE

There is a service charge payable of £1173.09 per annum split into four equal amounts of £293.27.

RATING ASSESSMENT

We are verbally advised by the Local Authority that the property is assessed for Council Tax purposes to Band A.

VACANT POSSESSION

Vacant possession will be given on completion and all fixtures and fittings mentioned in the above particulars are to be included in the sale.

MORTGAGE FACILITIES

We should be pleased to advise you in obtaining the best type of Mortgage to suit your individual requirements. **YOUR HOME IS AT RISK IF YOU DO NOT KEEP UP REPAYMENTS ON A MORTGAGE OR OTHER LOANS SECURED ON IT.**

Hunters Sheffield - Crookes 208 Crookes, Sheffield, S10 1TG | 0114 266 6626
sheffieldcrookes@hunters.com | www.hunters.com

GROUND FLOOR
423 sq.ft. (39.3 sq.m.) approx.

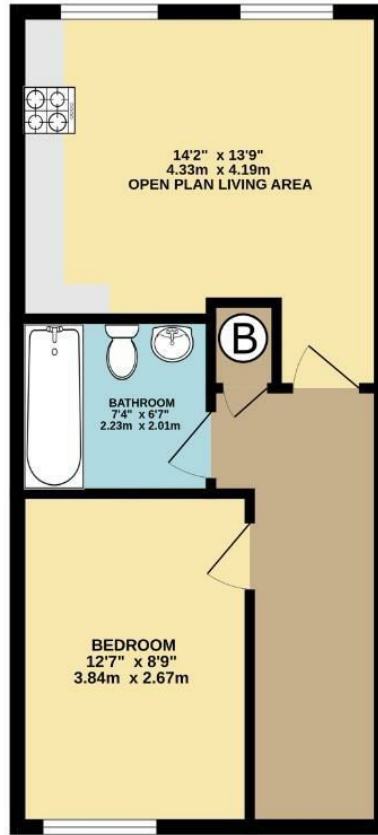

TOTAL FLOOR AREA: 423 sq.ft. (39.3 sq.m.) approx.

Whilst every attempt has been made to ensure the accuracy of the floorplan contained here, measurements of doors, windows, rooms and any other items are approximate and no responsibility is taken for any error, omission or mis-statement. This plan is for illustrative purposes only and should be used as such by any prospective purchaser. The services, systems and appliances shown have not been tested and no guarantee as to their operability or efficiency can be given.
Made with Metropix 5/2024

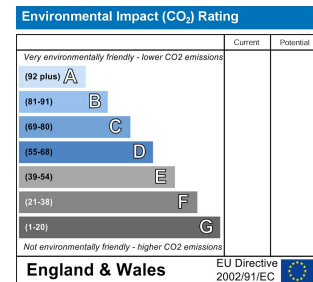
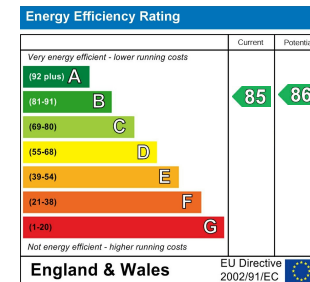

Energy Efficiency Rating

	Current	Potential
<i>Very energy efficient - lower running costs</i>		
(92 plus) A		
(81-91) B	85	86
(69-80) C		
(55-68) D		
(39-54) E		
(21-38) F		
(1-20) G		
<i>Not energy efficient - higher running costs</i>		
England & Wales	EU Directive 2002/91/EC	

These particulars are intended to give a fair and reliable description of the property but no responsibility for any inaccuracy or error can be accepted and do not constitute an offer or contract. We have not tested any services or appliances (including central heating if fitted) referred to in these particulars and the purchasers are advised to satisfy themselves as to the working order and condition. If a property is unoccupied at any time there may be reconnection charges for any switched off/disconnected or drained services or appliances - All measurements are approximate. If you are thinking of selling your home or just curious to discover the value of your property, Hunters would be pleased to provide free, no obligation sales and marketing advice. Even if your home is outside the area covered by our local offices we can arrange a Market Appraisal through our national network of Hunters estate agents.







