



Portside House, 29 Duke Street, Liverpool, L1 5AQ

£875 PCM

Berkeley Shaw are pleased to offer to rent this FURNISHED One bedroom FURNISHED apartment in Portside House. located in the heart of Liverpool City Centre and just a two minute walk from the Liverpool One shopping complex. The accommodation briefly comprises; entrance hall, living/dining room fully fitted kitchen, two bedrooms and a main bathroom. No Parking with this apartment

Deposit: £875.00

Council Tax: Band B

Minimum Term:12 months



Hallway

Entrance door , wooden floor, storage cupboard

Open Plan Lounge Kitchen

Double glazed widows, wooden floor in lounge area and tiled in kitchen area, kitchen comprises of a range of fitted base and wall units single drainer sink with mixer taps, electric oven an and Hob, extractor hood, freestanding washing machine and fridge freezer, 2 electric wall heaters furnishings include, table and chairs tv cabinet

Bedroom`

Double glazed window, carpet, wall heater, furnishings include bed and bedside cabinets wardrobe and chest of drawers, electric wall heqater

Bathroom

fully tiled walls and flooring, bath with fitted shower, sink and low leve w.c. ladder towel rail

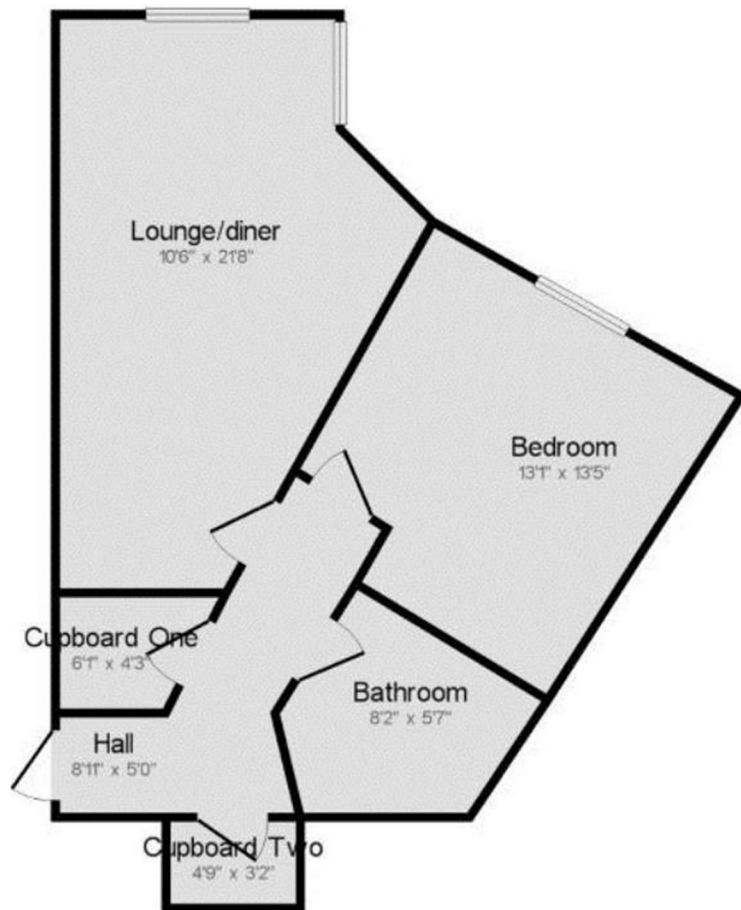

Ground Floor

Energy Efficiency Rating		
	Current	Potential
Very energy efficient - lower running costs		
(92 plus) A		86
(81-91) B		
(69-80) C	68	
(55-68) D		
(39-54) E		
(21-38) F		
(1-20) G		
Not energy efficient - higher running costs		
England & Wales	EU Directive 2002/91/EC	

Environmental Impact (CO ₂) Rating		
	Current	Potential
Very environmentally friendly - lower CO ₂ emissions		
(92 plus) A		77
(81-91) B		
(69-80) C	70	
(55-68) D		
(39-54) E		
(21-38) F		
(1-20) G		
Not environmentally friendly - higher CO ₂ emissions		
England & Wales	EU Directive 2002/91/EC	



Berkeley Shaw Estate Agents Limited.
Company No. 0784754

Berkeley Shaw Real Estate Limited.
Company No. 05206927

