

**£299,995**  
**3 Denham Close**  
Stubbington, PO14 2BQ



## PROPERTY SUMMARY

This three bedroom family home is situated within a highly sought after location between Stubbington Village and the beach. With a single garage in a block and driveway parking for two cars, this mid terraced house comprises an entrance hallway, a generous lounge with a beautiful feature log burner with an oak floating mantle, an open plan kitchen/diner with patio doors onto the south facing garden, three well-proportioned bedrooms and a family bathroom. This property is well presented and boasts gas central heating throughout, double glazing and is within great school catchments. Ideal for an investment or family home, this one is not to be missed! Call us now in our Stubbington Branch to book in your viewing today.





## **HALLWAY**

**LOUNGE** 12' 9" x 12' 6" (3.89m x 3.81m)

**KITCHEN/DINER** 15' 7" x 11' 6" (4.75m x 3.51m)

## **LANDING**

**MASTER BEDROOM** 12' 7" x 9' 6" (3.84m x 2.9m)

**BEDROOM TWO** 11' 1" x 9' 5" (3.38m x 2.87m)

**BEDROOM THREE** 9' x 6' 3" (2.74m x 1.91m)

**BATHROOM** 7' 1" x 5' 9" (2.16m x 1.75m)

## **OUTSIDE**

## **REAR GARDEN**

## **DRIVEWAY**

## **GARAGE IN A BLOCK**

## **AGENTS NOTES**

Please note that this property is steel framed.

GROUND FLOOR

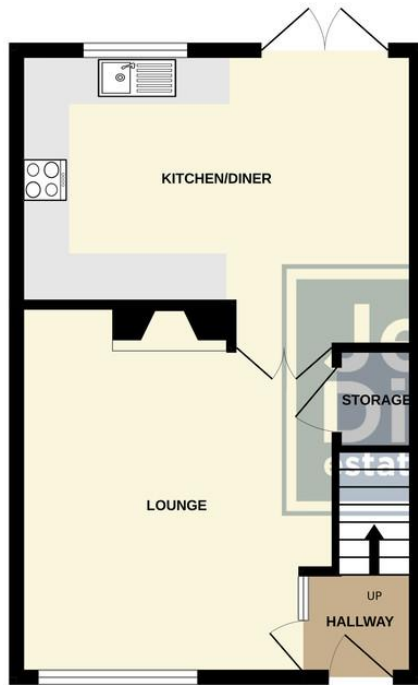

1ST FLOOR



Whilst every attempt has been made to ensure the accuracy of the floorplan contained here, measurements of doors, windows, rooms and any other items are approximate and no responsibility is taken for any error, omission or mis-statement. This plan is for illustrative purposes only and should be used as such by any prospective purchaser. The services, systems and appliances shown have not been tested and no guarantee as to their operability or efficiency can be given.  
Made with Metropix ©2025

**LOCAL AUTHORITY**  
Fareham Borough Council

**TENURE**  
Freehold

**COUNCIL TAX BAND**  
Band C

**VIEWINGS**  
By prior appointment only

**EPC TO FOLLOW**

Agents Note: Whilst every care has been taken to prepare these particulars, they are for guidance purposes only. All measurements are approximate and are for general guidance purposes only and whilst every care has been taken to ensure their accuracy, they should not be relied upon and potential buyers/tenants are advised to recheck the measurements

**Jeffries  
& Dibbens**  
estate and letting agents

**OFFICE ADDRESS**  
18 The Green, Stubbington,  
Fareham, Hampshire, PO14 2JG

**CONTACT**  
01329 668 511  
stubbington@dibbensproperty.co.uk  
www.jdea.co.uk