



£225,000

6 Solent Breezes, Chilling Lane

Warsash, SO31 9HG

PROPERTY SUMMARY

Qualifying for 12 month a year living, this semi-detached chalet is offered with no forward chain, situated on the foreshore of Southampton Water with beautiful panoramic views towards the Isle of Wight. The property benefits from an open plan living space/kitchen with sliding doors overlooking the scenic landscape, two double bedrooms and a large dual aspect shower room. Solent Breezes is located a short stroll from Brownhatch Beach and for those who like walking, the Solent Way coastal path is nearby where you can walk in the direction of Warsash and Hill Head. The Park itself is well maintained with a heated outdoor swimming pool, restaurant and bar, amusement arcade and entertainment programme. Further benefits include off road parking, a front garden area offering potential for further, private, outside seating, a storage shed and a fitted EV charger. We believe this to be a great opportunity for someone to secure a property with costal living. Please contact our Stubbington Branch today to secure your viewing.





ENTRANCE HALL

BEDROOM 1 13' 11" x 7' 5" (4.24m x 2.26m)

BEDROOM 2 9' 4" x 6' 2" (2.84m x 1.88m)

SHOWER ROOM 10' 2" x 4' 5" (3.1m x 1.35m)

KITCHEN 18' 3" x 6' 2" (5.56m x 1.88m)

LOUNGE 14' 7" x 13' 1" (4.44m x 3.99m)

GROUND FLOOR

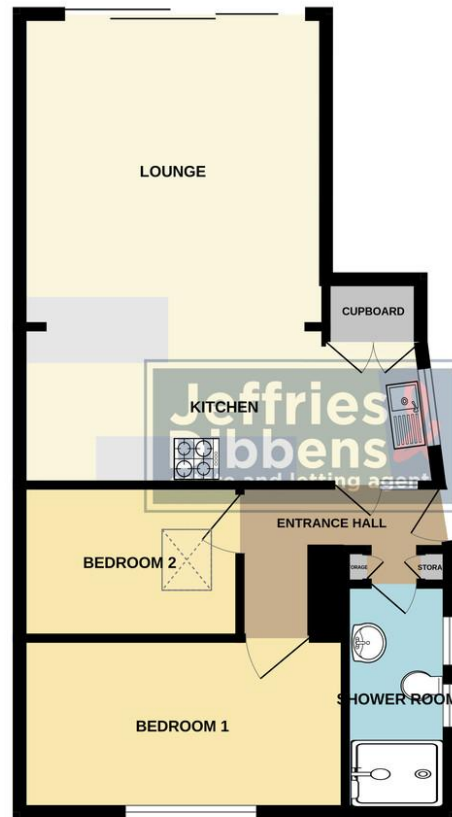

Whilst every attempt has been made to ensure the accuracy of the floorplan contained here, measurements of doors, windows, rooms and any other items are approximate and no responsibility is taken for any error.

LOCAL AUTHORITY
Fareham Borough Council

TENURE
Freehold

COUNCIL TAX BAND
Band C

VIEWINGS
By prior appointment only

Score	Energy rating	Current	Potential
92+	A		
81-91	B		84 B
69-80	C		
55-68	D		
39-54	E	48 E	
21-38	F		
1-20	G		

Agents Note: Whilst every care has been taken to prepare these particulars, they are for guidance purposes only. All measurements are approximate and are for general guidance purposes only and whilst every care has been taken to ensure their accuracy, they should not be relied upon and potential buyers/tenants are advised to recheck the measurements

**Jeffries
Dibbens**
estate and letting agents

OFFICE ADDRESS

18 The Green, Stubbington,
Fareham, Hampshire, PO14 2JG

CONTACT

01329 668 511
stubbington@dibbensproperty.co.uk
www.jdea.co.uk