

LIVERMORES

THE ESTATE AGENTS

3 Bedrooms

House - End Terrace

Price Guide

£450,000

Located in

Greenhithe



www.livermores.co.uk



34 High Street

Greenhithe DA9 9NN



GUIDE PRICE £450,000 - £475,000... Livermores are proud to present to the market this stunning and rarely available Grade II listed Georgian house. The property shows off with its charm and character, whilst comprising of three sizable bedrooms, family bathroom, lounge-diner and kitchen, over three floors.

The property is perfectly located within SHORT WALK TO GREENHITHE STATION, which has excellent access into London. Furthermore, the family home is also nestled in the heart of Greenhithe Village, where you can enjoy and visit all the local amenities, whilst having the opportunity for riverside strolls around the River Thames.

In addition, the property has excellent links to the A2 and the M25, whilst also offering a quick and easy bus journey to EBBSFLEET INTERNATIONAL STATION. The beautiful home is also closely located to Bluewater Shopping Centre, and within close proximity to excellent schools. VIEWING HIGHLY RECOMMENDED.



34 High Street

£450,000 Freehold



- GUIDE PRICE £450,000 - £475,000
- NESTLED IN THE HEART OF GREENHITHE VILLAGE
- EXCELLENT LINKS TO THE A2/M25
- BEAUTIFUL GARDEN SPACE
- OVER 1330 SQUARE FEET
- GRADE II LISTED GEORGIAN FAMILY HOME
- WALKING DISTANCE TO GREENHITHE STATION
- SCENIC WALKS WITH VIEWS OF THE RIVER THAMES
- EXCELLENT CHARM AND HISTORY
- COUNCIL TAX BAND 'D'



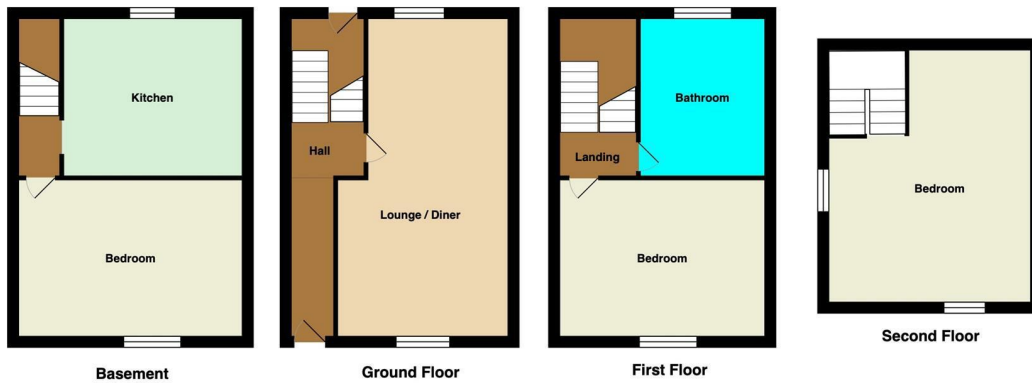

Council Tax Band D

Local Authority DARTFORD

Agents Note: Whilst every care has been taken to prepare these particulars, they are for guidance purposes only. All measurements are approximate and are for general guidance purposes only and whilst every care has been taken to ensure their accuracy, they should not be relied upon and potential buyers/tenants are advised to recheck the measurements.

| Energy Efficiency Rating | | |
|---|----------------------------|-----------|
| | Current | Potential |
| Very energy efficient - lower running costs | | |
| (92 plus) A | | |
| (81-91) B | | |
| (69-80) C | | |
| (55-68) D | | |
| (39-54) E | | |
| (21-38) F | | |
| (1-20) G | | |
| Not energy efficient - higher running costs | | |
| England & Wales | EU Directive 2002/91/EC | |

1 Hythe Street
 Dartford
 Kent
 DA1 1BE



dartford@livermores.co.uk
 01322 228090
 www.livermores.co.uk