

# HARRY CHARLES

Property Specialists



Smith Street, Watford, WD18 0AA

**£1,600 Per month**



**\*\* TWO BEDROOM, TWO BATHROOM TERRACED HOUSE - TOWN CENTRE LOCATION - 2 SEPARATE RECEPTION ROOMS - FITTED KITCHEN - DOWNSTAIRS SHOWER ROOM - MASTER BEDROOM WITH EN-SUITE BATHROOM - FURTHER DOUBLE BEDROOM - REAR GARDEN - AVAILABLE END OF JUNE 2025 \*\*** We are delighted to offer for let on an unfurnished basis this well presented two double bedroom terraced house situated in this Town Centre location. The property benefits from two separate receptions, a kitchen and shower room to the ground floor with two double bedrooms and an en-suite bathroom to the rear room to the first floor. Externally there is a covered area by the back door which leads to the courtyard rear garden. The property is sure to attract considerable interest so we would ask that you contact us without delay to arrange an early appointment to view. Council Tax Band C.

- Two Bedroom House
- Fitted Kitchen
- 2 Double Bedrooms
- Unfurnished
- Rear Garden
- 2 Separate Reception Rooms
- Downstairs Shower Room
- En-Suite Bathroom To Rear Bedroom
- Available Late June





Floor Plan

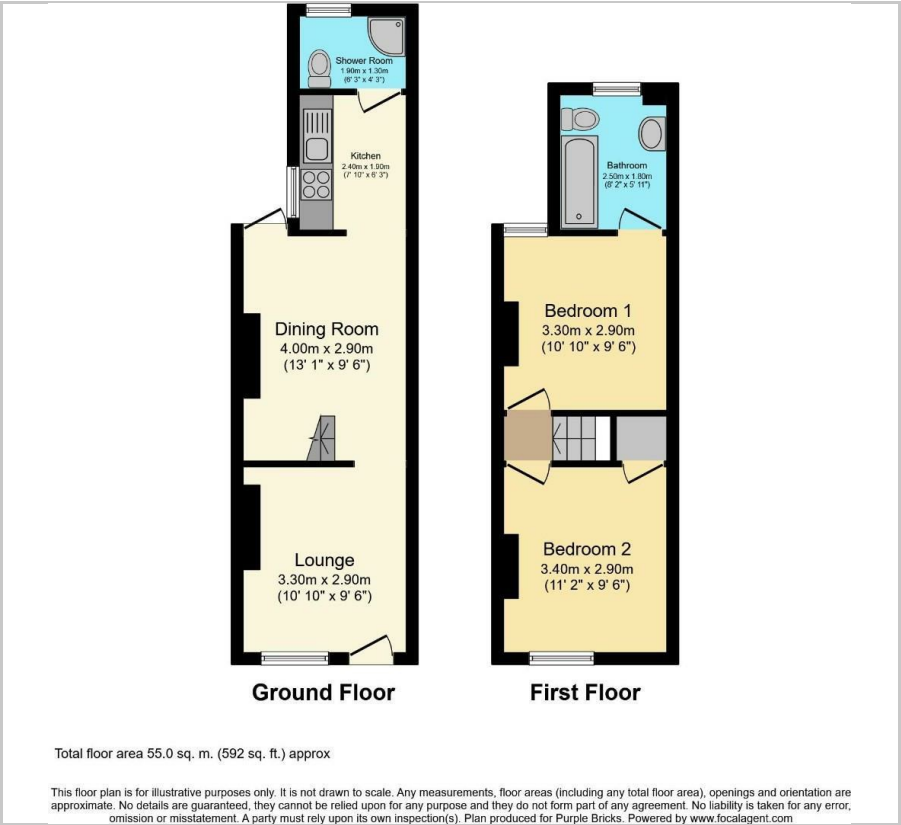

Area Map



Energy Efficiency Graph

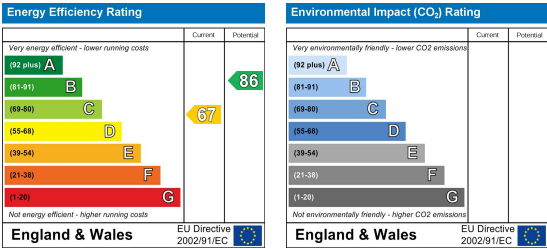

These particulars, whilst believed to be accurate are set out as a general outline only for guidance and do not constitute any part of an offer or contract. Intending purchasers should not rely on them as statements of representation of fact, but must satisfy themselves by inspection or otherwise as to their accuracy. No person in this firms employment has the authority to make or give any representation or warranty in respect of the property.