



1 Pye Nest Drive, Halifax, HX2 7HH

£895 Per Calendar Month

- HIGHLY REGARDED LOCATION
- KITCHEN
- BATHROOM
- GARDEN TO REAR

- LOUNGE
- THREE BEDROOMS
- DRIVEWAY LEADING TO SINGLE DETACHED GARAGE

bramleys

*****MINIMUM SIX MONTH LEASE*****

Situated in this highly regarded residential locality, is this 3 bedroomed semi detached property. Being well presented throughout, the property has uPVC double glazing and a gas fired central heating system together with modern fixtures and fittings. The property has accommodation comprising in brief:- entrance hall, lounge, kitchen, first floor landing 3 bedrooms and bathroom. Externally, there is a driveway providing off road parking, a single detached garage and a rear enclosed lawned garden. The property is offered to let on an unfurnished basis with immediate occupation. Bond £1030.00

*****SORRY NO PETS OR SMOKERS*****

Ground Floor



First Floor

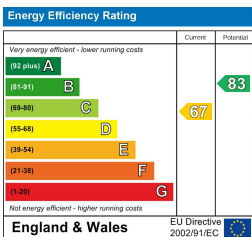
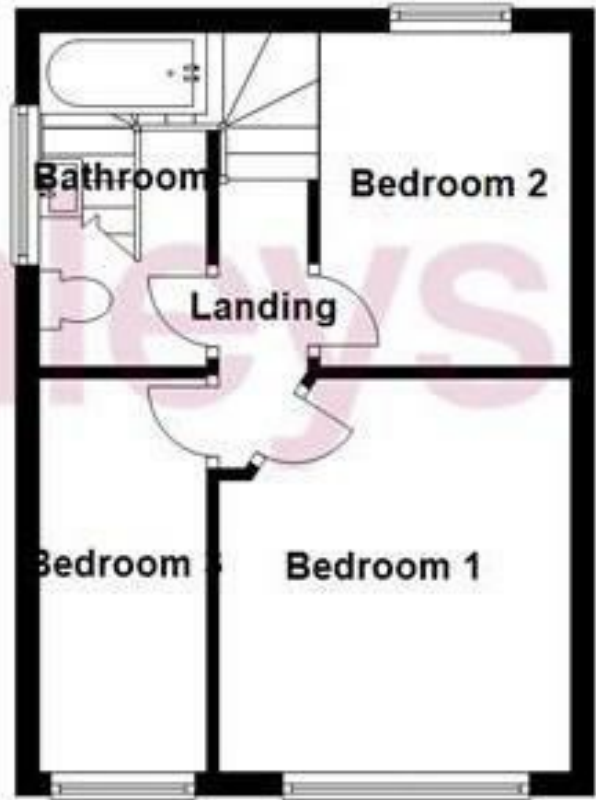

CONSUMER PROTECTION FROM UNFAIR TRADING REGULATIONS 2008

Bramleys, for themselves and for the Vendors or Lessors of this property, whose Agent they are, have made every effort to ensure the details given have been prepared in accordance with the above Act and to the best of our knowledge give a fair and reasonable representation of the property. Please note:

1. There is a six inch measurement tolerance, or metric equivalent, and the measurements given should not be entirely relied upon and purchasers must take their own measurements if ordering carpets, curtains or other equipment.
2. None of the mains services, i.e. gas, water, electricity, drainage or central heating system (if any) have been tested in any way whatsoever. This also includes appliances which are to be left insitu by the vendors.

PURCHASERS MUST SATISFY THEMSELVES AS TO THE CONDITION AND EFFECTIVENESS OF ANY SUCH APPLIANCES OR SERVICES. FLOOR PLANS NOT TO SCALE - FOR IDENTIFICATION PURPOSES ONLY