



BOWLING COURT

HENLEY-ON-THAMES, RG9 2LE

**PENNY &
SINCLAIR**

BOWLING COURT

HENLEY-ON-THAMES, RG9 2LE

A fabulous ground floor apartment, with a superb living space overlooking the fountain and grounds. Immaculately presented and occupying one of the best positions in this sought-after development.

With a refitted kitchen and smartly finished bathroom, along with light, airy and generous accommodation.

- Superb Ground Floor Apartment •
- Prime Position Overlooking Grounds & Fountain •
 - Beautifully Presented •
 - Re-fitted Kitchen •
- Generous Living Space •
 - Useful Storage •
- Gas Central Heating •
- No Chain •

DESCRIPTION

An elegant and beautifully finished apartment, with direct access and views over well-kept grounds and water feature.





ACCOMMODATION

A recessed storm porch leads into the entrance hall, with a useful storage cupboard and a further airing cupboard with shelving. The property has been redecorated and re-carpeted throughout and has a lovely, light and airy feel from the moment you step foot inside. The reception room is stunning, elegantly proportioned and with a large bay window with double doors leading out and overlooking the fountain, pond and beautifully kept grounds. The kitchen is an excellent size and smartly finished with a breakfast bar, ample wall and base units and a gas hob. The bedroom is a good size with a large fitted wardrobe and the shower room features a contemporary suite, with easy access to a double shower cubicle.

OUTSIDE

Bowling Court is a beautifully kept development, with wide ranging grounds and a feeling of tranquillity despite the excellent position close to town. There are lawns surrounding the ponds and fountain, and this property has the best view of all with double doors in the bay window leading directly to the fountain.



LOCATION

Bowling Court is one of the most sought-after retirement developments in Henley, set just off the Fairmile and a level walk to Phyllis Court, the river, Henley Town Centre and the comprehensive shopping facilities - all within 1/2 mile. Henley has a wealth of shops, bars and restaurants, two supermarkets, cinema, theatre as well as pleasant river walks along with the railway station that provides a service to London Paddington (55 mins.).

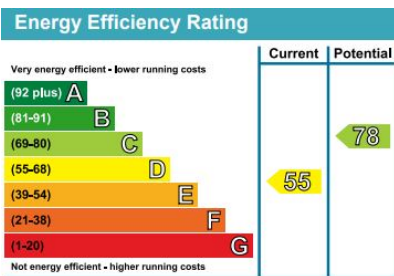

01491 739000

44 Hart Street, Henley-on-Thames,
Oxfordshire, RG9 2AU

henley.sales@pennyandsinclair.co.uk

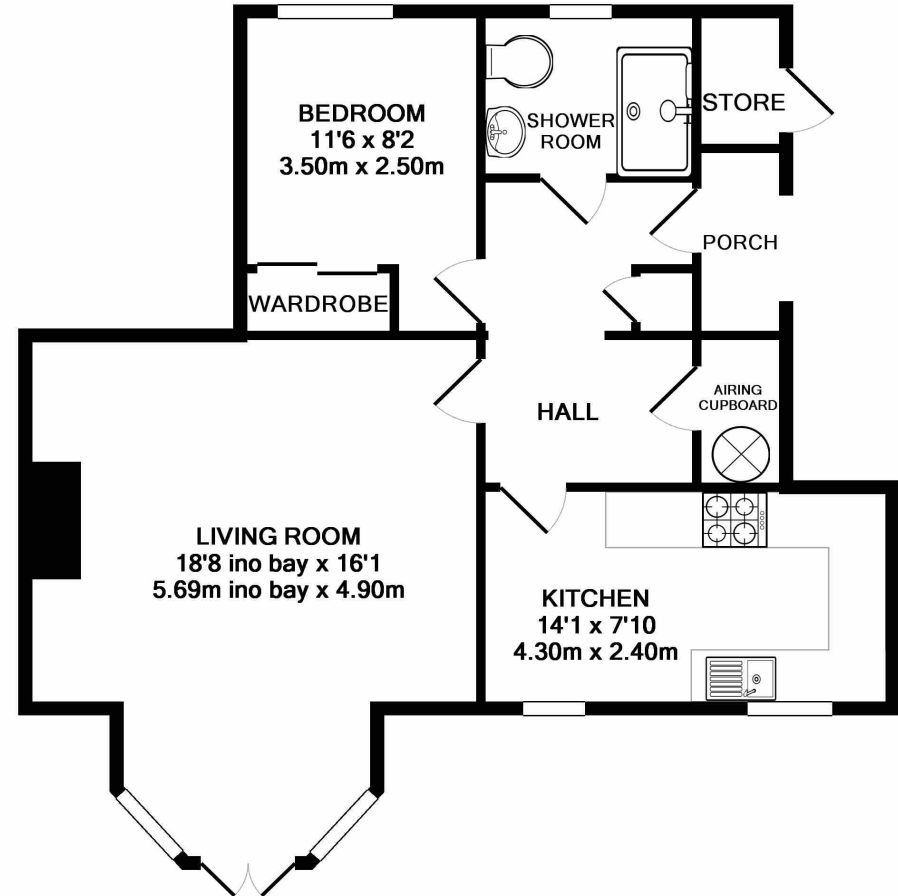

TOTAL APPROX. FLOOR AREA 627 SQ.FT. (58.3 SQ.M.)

Whilst every attempt has been made to ensure the accuracy of the floor plan contained here, measurements of doors, windows, rooms and any other items are approximate and no responsibility is taken for any error, omission, or mis-statement. This plan is for illustrative purposes only and should be used as such by any prospective purchaser. The services, systems and appliances shown have not been tested and no guarantee as to their operability or efficiency can be given

Made with Metropix ©2019

IMPORTANT NOTICE Penny & Sinclair, their clients and any joint agent gives notice to anyone reading these particulars that: i) the particulars do not constitute part of an offer or contract; ii) all descriptions, dimensions, references to the condition and necessary permissions for use and occupation, and other details are given without responsibility and any intending purchasers should not rely on them as statement or representations of fact. iii) the text, photographs and plans are guidelines only and are not necessarily comprehensive. Any reference to alterations to, or use of, any part of the property does not mean that all necessary planning, building regulations or other consents have been obtained and Penny & Sinclair have not tested any services, equipment or facilities. A buyer or lessee must satisfy themselves by inspection or otherwise. iv) the descriptions provided therein represent the opinion of the author and whilst given in good faith should not be construed as statements of fact; v) nothing in the particulars shall be deemed a statement that the property is in good condition or otherwise, nor that any services or facilities are in good working order; vi) no person in the employment of Penny & Sinclair has any authority to make or give any representation or warranty whatsoever in relation to this property. vii) all measurements are approximate.