



Connells

Sheppey Court Halfway Road
Halfway Road Sheerness



Step into this property and you will be impressed by the standard and size of the accommodation it offers, it has marvellous "kerb appeal" as the frontage is attractive and well-presented and maintained.

The Lounge is a comfortable place to relax with the well-equipped Kitchen leading off that has a range of fitted units and integrated appliances.

The property also benefits from a downstairs cloakroom.

Upstairs you have a good-sized Double Bedroom that is currently partitioned to give space for a nursery/dressing room.



The bathroom is well designed and maintained. This property must be viewed to appreciate the standard of this fantastic home that is comfortable of a good size and its location to local amenities.

ACCOMMODATION

Cloakroom

2' 8" x 6' 9" (0.81m x 2.06m)

Lounge

14' 6" x 11' 10" (4.42m x 3.61m)

Kitchen

6' 10" x 7' 2" (2.08m x 2.18m)

Bedroom 1

14' 5" x 9' 5" (4.39m x 2.87m)

Bedroom 2

10' 11" x 6' 5" (3.33m x 1.96m)

Bathroom

6' 11" x 6' 11" (2.11m x 2.11m)







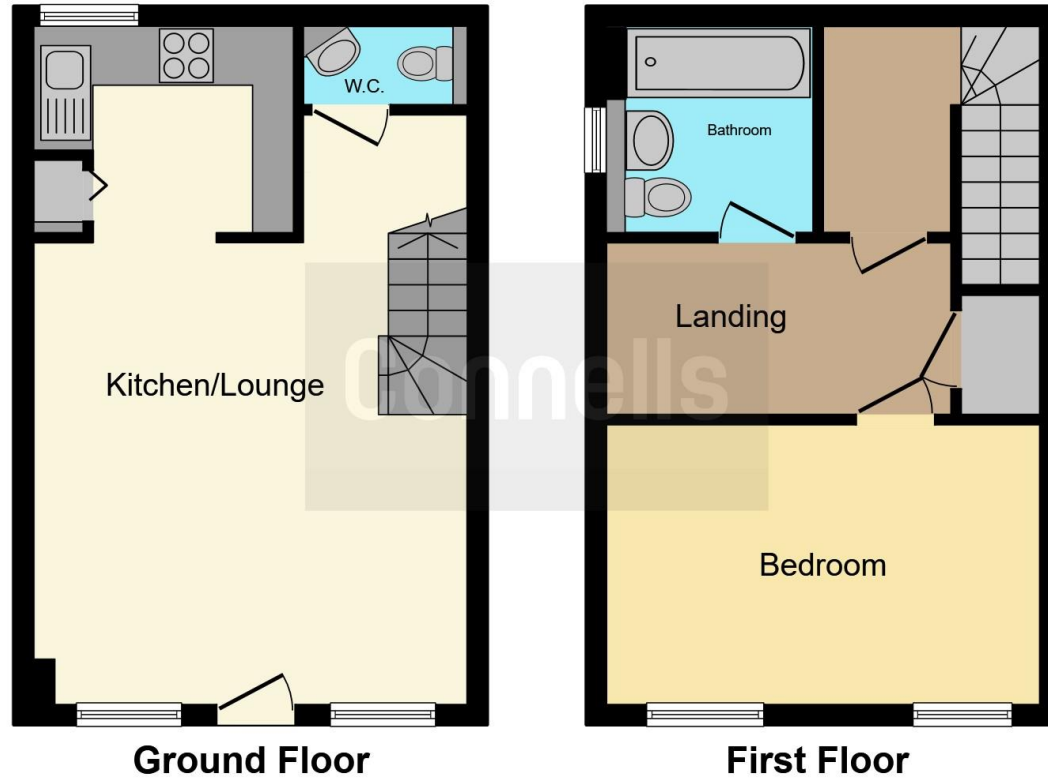

This floor plan is for illustrative purposes only. It is not drawn to scale. Any measurements, floor areas (including any total floor area), openings and orientation are approximate. No details are guaranteed, they cannot be relied upon for any purpose and they do not form part of any agreement. No liability is taken for any error, omission or misstatement. A party must rely upon its own inspection(s). Powered by www.focalagent.com

To view this property please contact Connells on

T 01795 533544
E faversham@connells.co.uk

7 Market Place
 FAVERSHAM ME13 7AG

EPC Rating: B

Tenure: Freehold

view this property online connells.co.uk/Property/SIT103368



1. MONEY LAUNDERING REGULATIONS Intending purchasers will be asked to produce identification documentation at a later stage and we would ask for your co-operation in order that there will be no delay in agreeing the sale. 2. These particulars do not constitute part or all of an offer or contract. 3. The measurements indicated are supplied for guidance only and as such must be considered incorrect. Potential buyers are advised to recheck measurements before committing to any expense. 4. We have not tested any apparatus, equipment, fixtures, fittings or services and it is in the buyers interest to check the working condition of any appliances.

Connells Residential is registered in England and Wales under company number 1489613, Registered Office is Cumbria House, 16-20 Hockliffe Street, Leighton Buzzard, Bedfordshire, LU7 1GN. VAT Registration Number is 500 2481 05.

See all our properties at www.connells.co.uk | www.rightmove.co.uk | www.zoopla.co.uk

Property Ref: SIT103368 - 0004