



2 Laverstoke Lane Bungalows Laverstoke Lane, Laverstoke,  
Whitchurch, RG28 7PA  
Guide Price £425,000



## 2 Laverstoke Lane Bungalows Laverstoke Lane, Laverstoke Whitchurch, Guide Price £425,000

PROPERTY DESCRIPTION BY Mr Ross Beeden

Graham & Co are delighted to offer to the market with no onward chain Laverstoke Lane Bungalows, a detached wooden framed bungalow with cedar cladding built by the Portals estate in the 1920s. Quietly located at the end of Laverstoke Lane the property adjoins and overlooks farmland.





Laverstoke is a popular village surrounded by attractive, open countryside. The property enjoys a peaceful location within the village, close to the tennis club and opposite the Millennium Green. In the village is the Watership Down Public house and Bombay Sapphire Gin Distillery and a huge number of attractive walks and public footpaths around the River Test and Test Valley . Laverstoke is close to the popular market town of Overton, which provides an excellent range of local amenities and a mainline railway station to London Waterloo.



# Laverstoke Lane Bungalows, RG28

Approximate Gross Internal Area = 120.5 sq m / 1297 sq ft  
 Garage / Shed = 36.3 sq m / 391 sq ft  
 Total = 156.8 sq m / 1688 sq ft

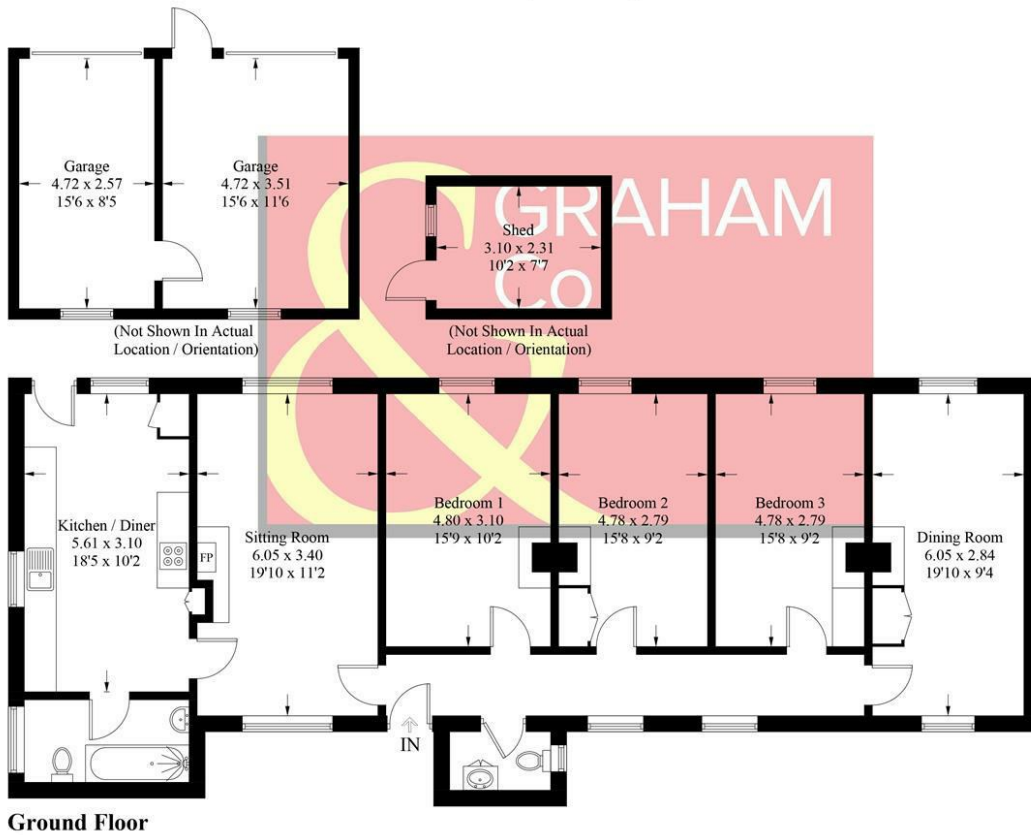

Ground Floor

PRODUCED FOR GRAHAM AND CO

Whilst every attempt has been made to ensure the accuracy of the floorplan, measurements of doors, windows and rooms are approximate. These plans are for representation purposes only as defined by RICS Code of Measuring Practice and used as such by any prospective purchaser. © Emzo Marketing (ID1091397)

## MORTGAGE ADVICE Across The Market Mortgages

An independent Mortgage brokerage offering expert advice from across the whole market. Whether you are a first-time buyer, home mover, remortgaging or buying a Buy-To-Let investment. Tristan can provide expert & reliable advice, in a clear jargon free language. Book a free consultation today.

E - [tristan@atmmortgages.com](mailto:tristan@atmmortgages.com) M - 07545320380 [www.atmmortgages.com](http://www.atmmortgages.com)

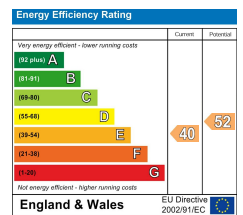

Tax Band: C



OPEN 7 DAYS

If you are considering selling your home please contact us today for your free no obligation valuation

IMPORTANT: we would like to inform prospective purchasers that these sales particulars have been prepared as a general guide only. A detailed survey has not been carried out, nor the services, appliances and fittings tested. Room sizes should not be relied upon for furnishing purposes and are approximate. If floor plans are included, they are for guidance only and illustration purposes only and may not be to scale. If there are any important matters likely to affect your decision to buy, please contact us before viewing the property.

