



4 Fishers Field, St. Mary Bourne, Andover, SP11 6BH
Guide Price £450,000



4 Fishers Field, St. Mary Bourne Andover, Guide Price £450,000

PROPERTY DESCRIPTION BY Mr Dion McArthur

Welcome to this charming property located in the picturesque village of Fishers Field, St. Mary Bourne, Andover. This delightful house boasts a large reception room, and a kitchen/diner perfect for entertaining guests or simply relaxing with your loved ones. With 3 cosy bedrooms, there's plenty of space for the whole family to unwind and enjoy a good night's sleep.

One of the highlights of this property is the two bathrooms, one conveniently located downstairs with a utility area and another upstairs, providing added convenience for busy mornings or when guests come to visit. The recent renovation this property has undergone ensures a modern and fresh feel throughout, making it move-in ready for its new owners.

Situated in a village location, you'll enjoy the tranquillity and community spirit that comes with such a setting. The views surrounding the property are simply breath-taking, offering a peaceful and idyllic backdrop to everyday life. The driveway parking adds a practical touch, ensuring you never have to worry about finding a spot for your vehicle after a long day.

Don't miss out on the opportunity to make this house your home. Embrace village living at its finest and create lasting memories in this beautifully renovated property.





The village of St Mary Bourne, situated in the centre of the beautiful Bourne Valley, is inside the North Wessex Downs Area of Outstanding Natural Beauty, just 5 miles to the north east of Andover, close to Whitchurch and easily accessible from the A34, A303 and A343, both Andover and Whitchurch have mainline train stations with fast service to London. The village itself has a centre which overlooks a picturesque recreation ground with adjoining lake, bowling green, sports area and Village shop with Post Office. Nearby Andover offers a good range of shopping theatre cinema new leisure centre and college for higher education



Fishers Field, SP11

Approximate Gross Internal Area = 90.4 sq m / 973 sq ft
(Excluding Boiler Room)

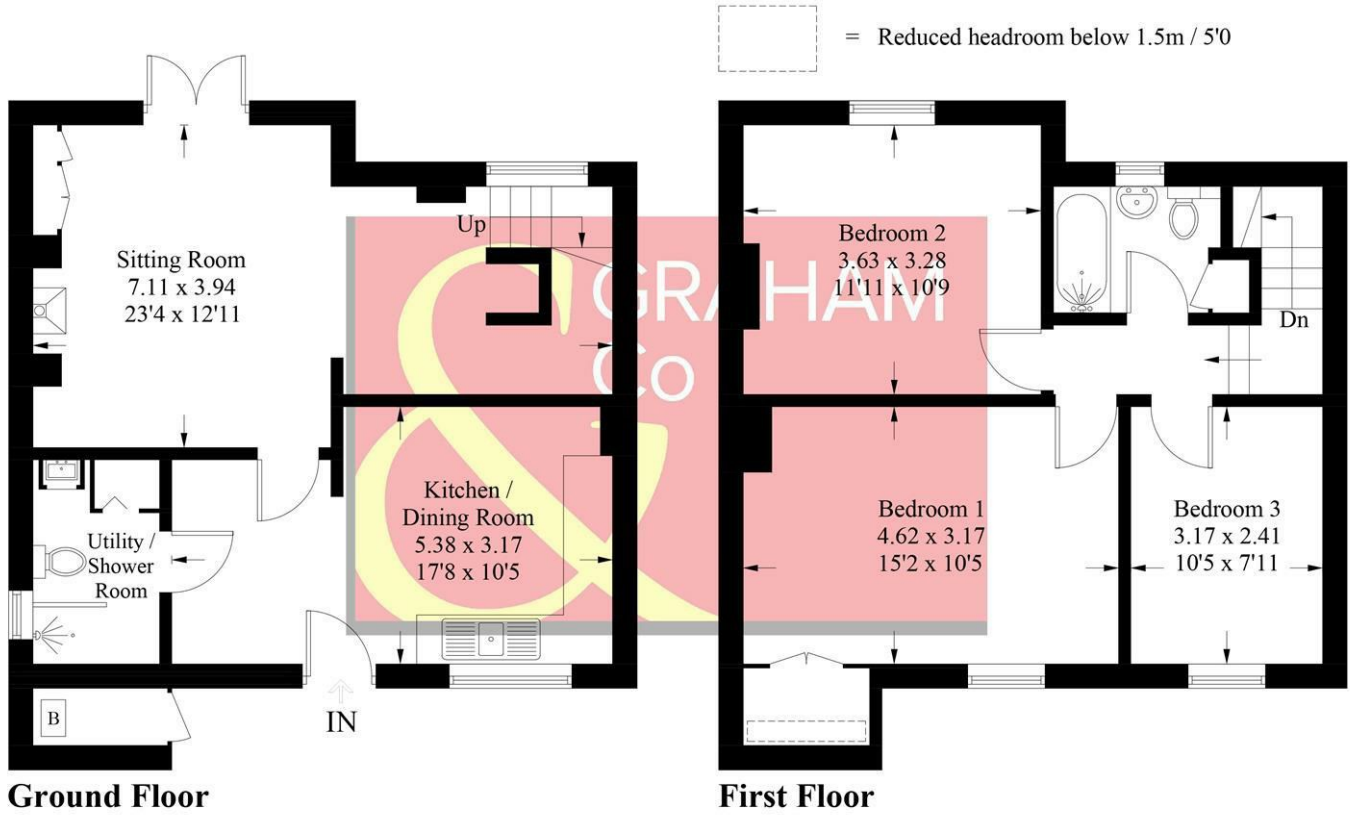

PRODUCED FOR GRAHAM AND CO

Whilst every attempt has been made to ensure the accuracy of the floorplan, measurements of doors, windows and rooms are approximate. These plans are for representation purposes only as defined by RICS Code of Measuring Practice and used as such by any prospective purchaser. © Emzo Marketing (ID1060536)

MORTGAGE ADVICE Across The Market Mortgages

An independent Mortgage brokerage offering expert advice from across the whole market. Whether you are a first-time buyer, home mover, remortgaging or buying a Buy-To-Let investment. Tristan can provide expert & reliable advice, in a clear jargon free language. Book a free consultation today.

E - tristan@atmmortgages.com M - 07545320380

www.atmmortgages.com

Energy Efficiency Rating		Current	Potential
Very energy efficient - lower running costs			
(95 plus) A			80
(81-91) B			
(69-80) C			
(55-68) D		59	
(39-54) E			
(21-38) F			
(1-20) G			
Not energy efficient - higher running costs			
England & Wales EU Directive 2002/91/EC			

Tax Band: D



OPEN 7 DAYS

If you are considering selling your home please contact us today for your free no obligation valuation

IMPORTANT: we would like to inform prospective purchasers that these sales particulars have been prepared as a general guide only. A detailed survey has not been carried out, nor the services, appliances and fittings tested. Room sizes should not be relied upon for furnishing purposes and are approximate. If floor plans are included, they are for guidance only and illustration purposes only and may not be to scale. If there are any important matters likely to affect your decision to buy, please contact us before viewing the property.