



FOR SALE

2 Bed Mid Terraced House in Danvers Road, Leicester LE3 2AE
Offers Over £190,000

Well presented and well proportioned bay fronted mid terrace house for sale in the heart of the West End. The accommodation comprises lounge, dining room, kitchen, two double bedrooms, modern bathroom and rear yard. Ideal first time buyer property or downsizing from a larger home.



GROUND FLOOR
404 sq ft. (37.5 sq.m.) approx.

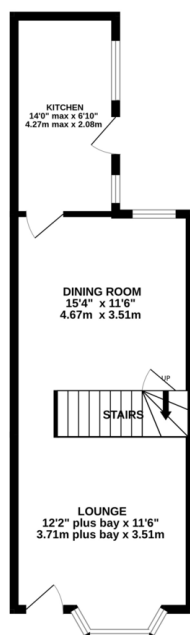

1ST FLOOR
396 sq ft. (36.8 sq.m.) approx.

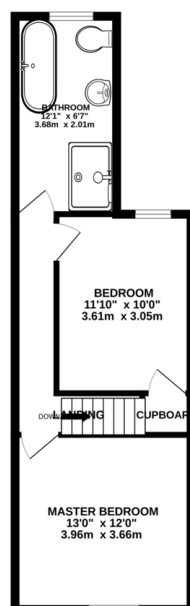

TOTAL FLOOR AREA: 800 sq ft. (74.3 sq.m.) approx.
Whilst every attempt has been made to ensure the accuracy of the floorplan, measurements of doors, windows, rooms and any other items are approximate and no responsibility is taken for any error, omission or misstatement. This plan is for illustrative purposes only and should be used as such by any prospective purchaser. The services, systems and appliances shown have not been tested and no guarantee as to their operability or efficiency can be given.
Made with Netplan 12/2020

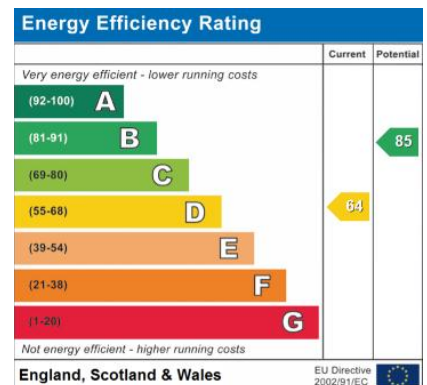

- Bay Fronted
- Mid Terrace
- Two Double Bedrooms
- New Boiler 2023
- Well Presented Throughout
- Close To Amenities
- Popular Schools Close By
- Easy Access To City Centre & Motorways

Agents Note: Whilst every care has been taken to prepare these sales particulars, they are for guidance purposes only. All measurements are approximate are for general guidance purposes only and whilst every care has been taken to ensure their accuracy, they should not be relied upon and potential buyers are advised to recheck the measurements.

