



TO LET

2 Bed End Terraced House in Glengate, Wigston LE18 4SP
£900 pcm

Two bedroom terraced property in South Wigston available to let. Comprising two reception rooms and kitchen downstairs, with two double bedrooms and bathroom upstairs, the property is in excellent condition throughout. Parking is available on street to the front of the property and there is a small private garden to the rear.



GROUND FLOOR
310 sq.ft. (28.8 sq.m.) approx.

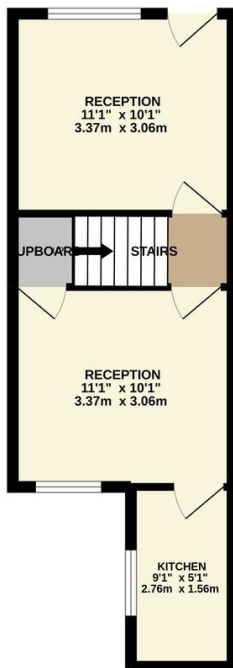

FIRST FLOOR
332 sq.ft. (30.8 sq.m.) approx.



FLOORPLAN BY PHILLIPS GEORGE ESTATE AGENTS

TOTAL FLOOR AREA: 641 sq.ft. (59.6 sq.m.) approx.

Whilst every attempt has been made to ensure the accuracy of the floorplan contained herein, measurements of doors, windows, rooms and any other items are approximate and no responsibility is taken for any error, omission or mis-statement. This plan is for illustrative purposes only and should be used as such by any prospective purchaser. The services, systems and appliances shown have not been tested and no guarantee as to their operability or efficiency can be given.
Made with Metronix ©2022

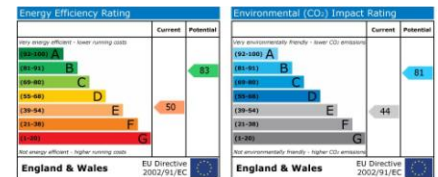

- End Terraced Home
- Two Bedrooms
- Two Reception Rooms
- Bedroom Off Second Bedroom
- Renovated Throughout
- New Carpets & Paintwork
- Sorry No Pets
- Offered Unfurnished

Agents Note: Whilst every care has been taken to prepare these sales particulars, they are for guidance purposes only. All measurements are approximate are for general guidance purposes only and whilst every care has been taken to ensure their accuracy, they should not be relied upon and potential buyers are advised to recheck the measurements.

