



TO LET

2 Bed Mid Terraced House in Danvers Road, Leicester LE3 2AE
£1,000 pcm

Well presented pallisaded bay fronted two bedroom terraced home available to rent on Danvers Road in the West End of Leicester. The property has been well maintained and comprises two reception rooms, galley kitchen, downstairs WC, together with two double bedrooms and bathroom on the first floor. the property also benefits from a low maintenance outdoor space to the rear and convenient links to local amenities.



GROUND FLOOR
439 sq.ft. (40.8 sq.m.) approx.



1ST FLOOR
421 sq.ft. (39.1 sq.m.) approx.

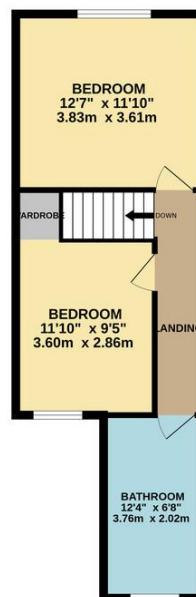

Energy Efficiency Rating		Current	Potential
Very energy efficient - lower running costs			
(92+)	A		
(81-91)	B		87
(69-80)	C		
(55-68)	D	61	
(39-54)	E		
(21-38)	F		
(1-20)	G		
Not energy efficient - higher running costs			
England & Wales		EU Directive 2002/91/EC	
www.epc4u.com			

- Two Double Bedrooms
- Pallisaded Bay Fronted Terrace
- Two Reception Rooms
- Galley Kitchen
- Additional Downstairs WC
- Bathroom Upstairs
- Combi Boiler
- Double Glazing Throughout

Agents Note: Whilst every care has been taken to prepare these sales particulars, they are for guidance purposes only. All measurements are approximate and are for general guidance purposes only and whilst every care has been taken to ensure their accuracy, they should not be relied upon and potential buyers are advised to recheck the measurements.

