



FOR SALE

3 Bed Semi-Detached House in Linford Close, Wigston, LE18 3PZ
£270,000

*** No Chain *** Well presented and well proportioned semi detached house for sale on the Meadows Estate in Wigston. The property backs on to the local primary school and is also close to a selection of amenities. The accommodation comprises entrance hall, lounge, kitchen diner, conservatory, three bedrooms, bathroom, rear garden and ample off road parking. An ideal family home.



GROUND FLOOR
513 sq.ft. (47.6 sq.m.) approx.

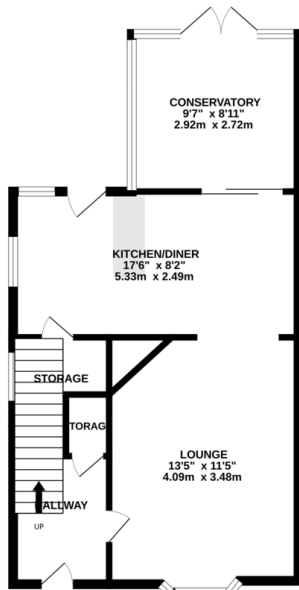

1ST FLOOR
408 sq.ft. (37.9 sq.m.) approx.

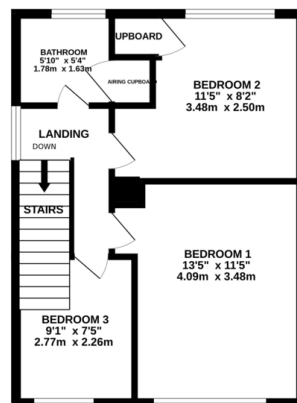

TOTAL FLOOR AREA: 921 sq.ft. (85.5 sq.m.) approx.
Whilst every attempt has been made to ensure the accuracy of the floorplans contained here, measurements of doors, windows, rooms and any other items are approximate and no responsibility is taken for any error, omission or mis-statement. This plan is for illustrative purposes only and should be used as such by any prospective purchaser. The services, systems and appliances shown here are not tested and no guarantee as to their operability or efficiency can be given. Made with Metropix ©2025

EPC to follow

- No Chain
- Semi Detached
- Three Bedrooms
- Ideal Family Home
- Close To Local School
- Ample Off Road Parking
- Conservatory
- Kitchen Diner

Agents Note: Whilst every care has been taken to prepare these sales particulars, they are for guidance purposes only. All measurements are approximate are for general guidance purposes only and whilst every care has been taken to ensure their accuracy, they should not be relied upon and potential buyers are advised to recheck the measurements.

