



## FOR SALE

3 Bed Semi-Detached House in Meadow Hill, Wigston, LE18 3UA  
£275,000

\*\*\* No Chain \*\*\* Modern three bedroom semi detached family home for sale in a peaceful yet popular part of Wigston. This property is in excellent condition throughout and comprises entrance hall, downstairs WC, spacious lounge, kitchen diner, three bedrooms, en suite to master bedroom, family bathroom upstairs, ample off road parking and garden to the rear.



GROUND FLOOR  
450 sq.ft. (41.8 sq.m.) approx.

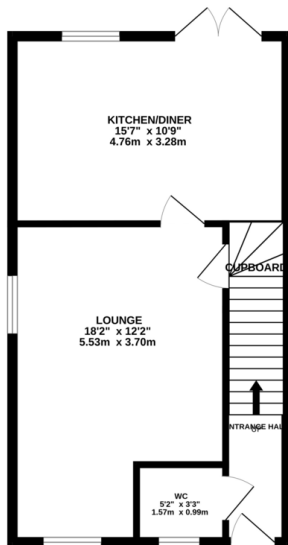

1ST FLOOR  
450 sq.ft. (41.8 sq.m.) approx.

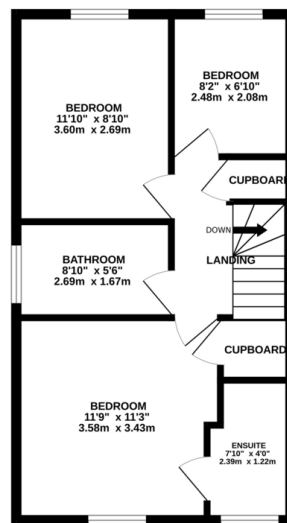

TOTAL FLOOR AREA: 901 sq.ft. (82.7 sq.m.) approx.  
While every attempt has been made to ensure the accuracy of the floorplans contained here, measurements of doors, windows, rooms and any other areas are approximate and no responsibility is taken for any error, omission or mis-statement. This plan is for illustrative purposes only and should be used as such by any prospective purchaser. The services, systems and appliances shown here are not been tested and no guarantee as to their condition or efficiency can be given.  
Made with Hingeplan ©2022

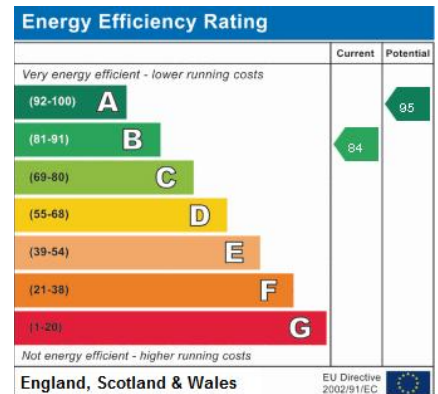

- No Chain
- Semi Detached
- Three Bedrooms
- Excellent Condition Throughout
- Kitchen Diner
- Off Road Parking
- En Suite Bathroom
- Downstairs WC

**Agents Note:** Whilst every care has been taken to prepare these sales particulars, they are for guidance purposes only. All measurements are approximate and for general guidance purposes only and whilst every care has been taken to ensure their accuracy, they should not be relied upon and potential buyers are advised to recheck the measurements.

