



FOR SALE

2 Bed Mid Terraced House in Mostyn Street, Leicester LE3 6DU
£160,000

Offered with no upward chain this two bedroom mid terrace is located in the highly sought after West End borders of Leicester. The accommodation comprises of entrance to dining room, cellar, lounge, kitchen, landing to two bedrooms and bathroom, landscaped rear yard. Contact Phillips George to view.



BASEMENT
142 sq ft. (13.2 sq m.) approx.

GROUND FLOOR
328 sq ft. (30.5 sq m.) approx.

1ST FLOOR
328 sq ft. (30.5 sq m.) approx.

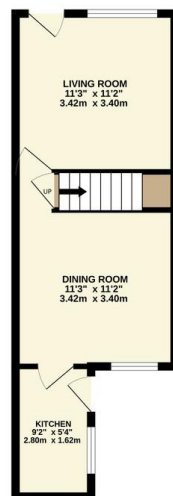
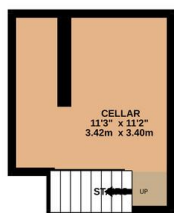

TOTAL FLOOR AREA: 797 sq ft. (74.1 sq m.) approx.

Whilst every attempt has been made to ensure the accuracy of the description contained here, measurements of doors, windows, rooms and other details are approximate and no responsibility is taken for any error, omission or misstatement. This plan is for illustrative purposes only and should be used as such for any prospective purchase. The services, systems and appliances shown have not been tested and no guarantee as to their operability or efficiency can be given.
Made with Metropix ©2024

EPC To Follow

- No Chain
- Mid Terrace
- Two Bedrooms
- Highly Popular Location
- Two Double Bedrooms
- Bathroom
- Landscaped Yard
- On Street Parking

Agents Note: Whilst every care has been taken to prepare these sales particulars, they are for guidance purposes only. All measurements are approximate are for general guidance purposes only and whilst every care has been taken to ensure their accuracy, they should not be relied upon and potential buyers are advised to recheck the measurements.

