



FOR SALE

2 Bed Town House in Thistley Close, Thorpe Aslley, LE3 3RZ
£215,000

*** No Chain *** Ideal first time buy or investment property which has undergone a schedule of improvements to include a new kitchen, re-decoration throughout, new carpets and new composite front door. Nestled on a private drive is this two bed mid town house. The accommodation comprises entrance hall, downstairs w.c., lounge, breakfast kitchen, two double bedrooms, family bathroom, off road parking and rear garden. The property is ideally located close to a selection of amenities and the motorway/ring road networks.



GROUND FLOOR
321 sq.ft. (29.8 sq.m.) approx.

1ST FLOOR
290 sq.ft. (26.9 sq.m.) approx.

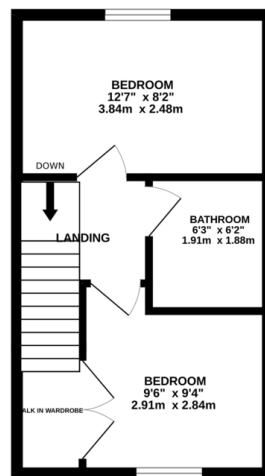
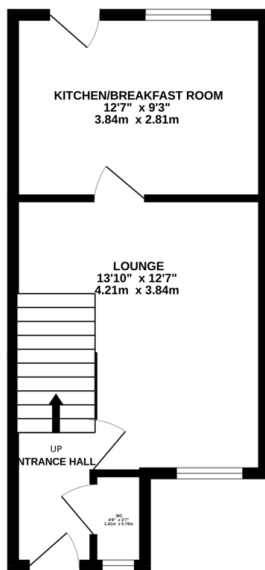

TOTAL FLOOR AREA: 611 sq.ft. (56.7 sq.m.) approx.

Whilst every attempt has been made to ensure the accuracy of the description contained herein, measurements of doors, windows, rooms and any other items are approximate and no responsibility is taken for any error, omission or misstatement. This plan is for illustrative purposes only and should be used as such by any prospective purchaser. The services, systems and appliances shown have not been tested and no guarantee as to their operability or efficiency can be given.
Made with Hologram ©2022

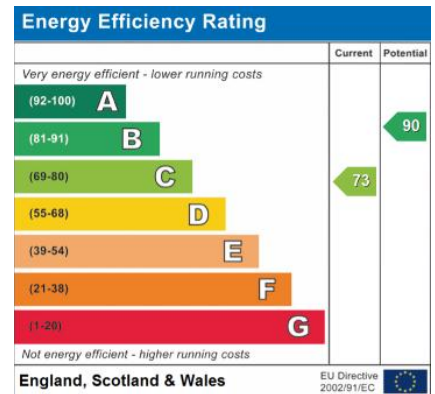

- No Chain
- Close To Amenities
- Two Double Bedrooms
- Off Road Parking
- Downstairs W.C.
- New Kitchen
- Re-Decorated Throughout
- Access To Motorways & Ring Road

Agents Note: Whilst every care has been taken to prepare these sales particulars, they are for guidance purposes only. All measurements are approximate are for general guidance purposes only and whilst every care has been taken to ensure their accuracy, they should not be relied upon and potential buyers are advised to recheck the measurements.

