



FOR SALE

3 Bed Semi-Detached House in Ruskington Drive, Wigston LE18 1LA
£240,000

With no upward chain this three bedroom semi detached family home is pleasantly situated close to Knighton Park in Wigston and presents an ideal renovation project. The accommodation comprises main entrance hall, lounge, kitchen diner, landing to three bedrooms and bathroom, landscaped front and rear gardens, off road parking and rear detached garage. Call Phillips George to view.



GROUND FLOOR
351 sq.ft. (32.6 sq.m.) approx.

1ST FLOOR
354 sq.ft. (32.9 sq.m.) approx.

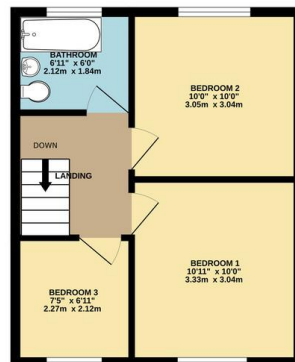
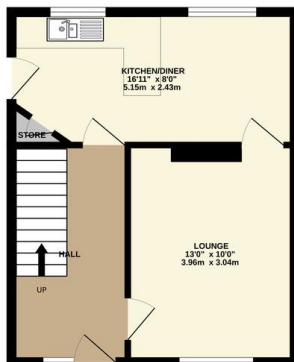

TOTAL FLOOR AREA : 705 sq.ft. (65.5 sq.m.) approx.
Whilst every attempt has been made to ensure the accuracy of the floorplan contained here, measurements of doors, windows, rooms and any other items are approximate and no responsibility is taken for any error, omission or mis-statement. This plan is for illustrative purposes only and should be used as such by any prospective purchaser. The services, systems and appliances shown have not been tested and no guarantee as to their operability or efficiency can be given.
Made with Metropac (2012).

EPC To Follow

- No Upward Chain
- Requiring Modernisation
- Semi Detached
- Three Bedrooms
- Highly Popular Location
- Close To Knighton Park
- Landscaped Gardens
- Off Road Parking

Agents Note: Whilst every care has been taken to prepare these sales particulars, they are for guidance purposes only. All measurements are approximate and for general guidance purposes only and whilst every care has been taken to ensure their accuracy, they should not be relied upon and potential buyers are advised to recheck the measurements.

