



FOR SALE

3 Bed Town House in Gretna Way, Thurnby Lodge LE5 2PQ
£240,000

With no upward chain this three bedroom immaculately presented mid town house is situated in the popular Thurnby Lodge estate of Leicester. The accommodation comprises main entrance hall, lounge, fitted kitchen, utility area, landing to three bedrooms, bathroom, landscaped gardens to the front and rear, on street parking. The property would ideally suit a first time family looking for a forever home. Call Phillips George to view.



GROUND FLOOR
417 sq.ft. (38.7 sq.m.) approx.

1ST FLOOR
420 sq.ft. (39.0 sq.m.) approx.

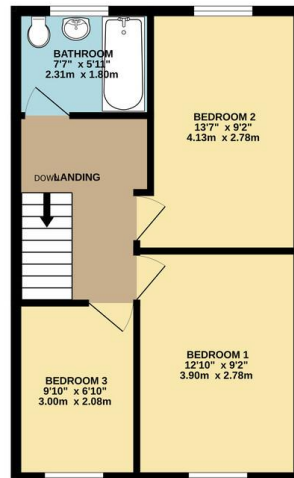
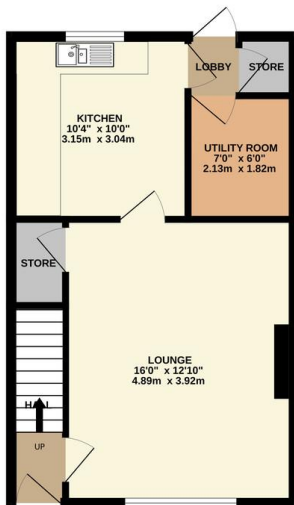

TOTAL FLOOR AREA : 837 sq.ft. (77.7 sq.m.) approx.
Whilst every attempt has been made to ensure the accuracy of the floorplan contained here, measurements of doors, windows, rooms and any other items are approximate and no responsibility is taken for any error, omission or mis-statement. This plan is for illustrative purposes only and should be used as such by any prospective purchaser. The services, systems and appliances shown have not been tested and no guarantee as to their operability or efficiency can be given.
Made with Metropix CS024

EPC To Follow.

- Mid Town House
- Three Bedrooms
- No Upward Chain
- Thurnby Lodge
- Immaculately Presented Throughout
- Landscaped Gardens
- Fitted Kitchen
- Ideal First Time Buy

Agents Note: Whilst every care has been taken to prepare these sales particulars, they are for guidance purposes only. All measurements are approximate are for general guidance purposes only and whilst every care has been taken to ensure their accuracy, they should not be relied upon and potential buyers are advised to recheck the measurements.

