



FOR SALE

2 Bed Mid Terraced House in Nutfield Road, West End, Leicester LE3
1AN

£180,000

Located in the highly popular West End of Leicester sits this two bedroom well presented mid terrace being offered for sale with no upward chain. Benefiting from a refurbished kitchen the property also comprises main entrance to lounge, dining room, kitchen, landing to two bedrooms and bathroom, rear landscaped yard with a series of outbuildings, on street parking. Close to a range of local amenities including Fullhurst College. The property would ideally suit a first time buyer or investment opportunists. Call Phillips George to view.



GROUND FLOOR
367 sq.ft. (34.1 sq.m.) approx.

1ST FLOOR
393 sq.ft. (36.3 sq.m.) approx.

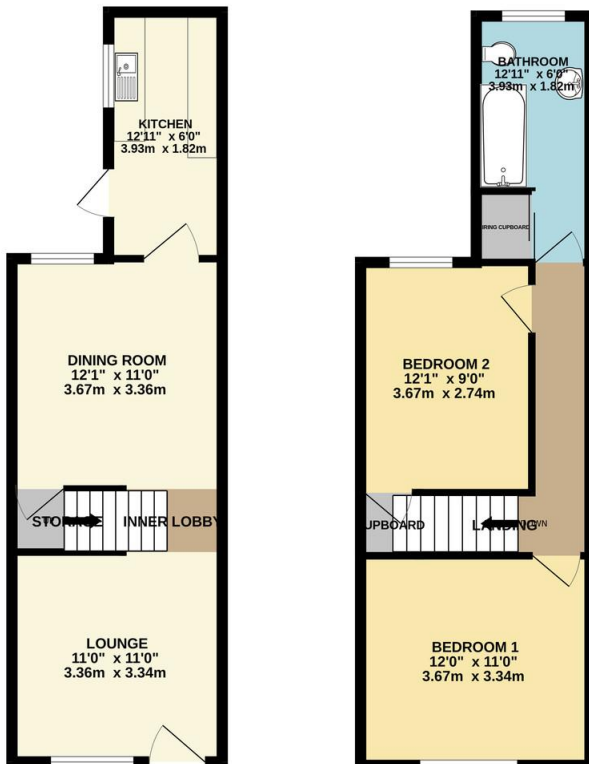

TOTAL FLOOR AREA: 760 sq.ft. (70.6 sq.m.) approx.

Whilst every attempt has been made to ensure the accuracy of the floorplan contained herein, measurements of doors, windows, rooms and any other items are approximate and no responsibility is taken for any error, omission or mis-statement. This plan is for illustrative purposes only and should be used as such by any prospective purchaser. The services, systems and appliances shown have not been tested and no guarantee as to their operability or efficiency can be given.
Made with Metrage ©2024

Agents Note: Whilst every care has been taken to prepare these sales particulars, they are for guidance purposes only. All measurements are approximate and for general guidance purposes only and whilst every care has been taken to ensure their accuracy, they should not be relied upon and potential buyers are advised to recheck the measurements.

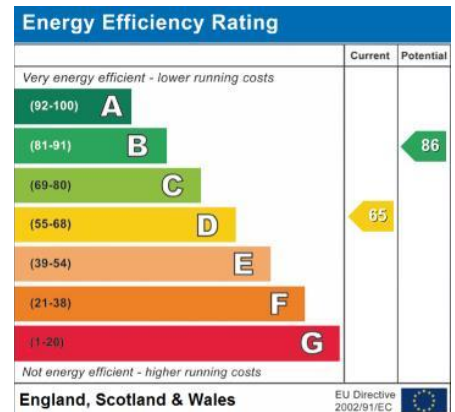

- No Upward Chain
- Mid Terrace
- Well Presented Throughout
- Refurbished Kitchen
- Two Bedrooms
- On Street Parking
- Landscaped Yard
- Highly Popular Location

