



FOR SALE

2 Bed Semi-Detached Bungalow in Derwent Walk, Oadby, LE2 4JB
Guide Price £220,000

Nestled in a quiet cul de sac within the highly desirable location of Oadby sits this two bedroom semi detached bungalow. The accommodation comprises entrance hall, lounge, fitted kitchen, two bedrooms, bathroom, landscaped gardens, driveway and garage. Call Phillips George to view.



GROUND FLOOR
565 sq.ft. (52.5 sq.m.) approx.

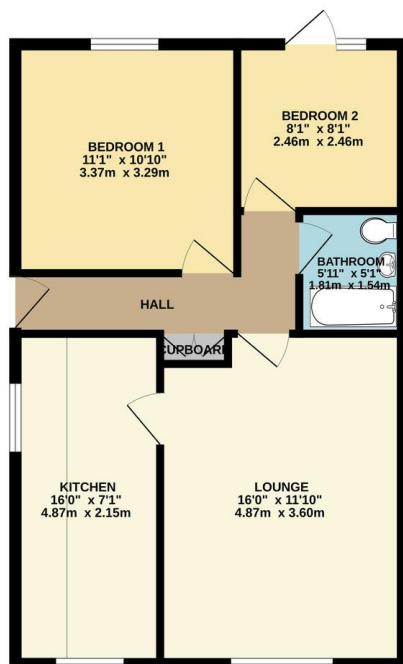

TOTAL FLOOR AREA: 565 sq.ft. (52.5 sq.m.) approx.
Whilst every attempt has been made to ensure the accuracy of the floorplans contained here, measurements of doors, windows, rooms and any other items are approximate and no responsibility is taken for any error, omission or mis-statement. This plan is for guidance purposes only and should be used as such by any prospective purchaser. The services, fixtures and appliances shown here have been listed and no guarantee is given to their operability or efficiency can be given.
Made with Hoxpox 12024

Energy Efficiency Rating		Current	Potential
Very energy efficient - lower running costs			
(92-100)	A		
(81-91)	B		87
(69-80)	C		
(55-68)	D	87	
(39-54)	E		
(21-38)	F		
(1-20)	G		
Not energy efficient - higher running costs			
England, Scotland & Wales		EU Directive 2002/91/EC	

- Semi Detached
- Bungalow
- Two Bedrooms
- Cul De Sac
- Highly Popular Location
- Off Road Parking
- Garage
- Gardens

Agents Note: Whilst every care has been taken to prepare these sales particulars, they are for guidance purposes only. All measurements are approximate are for general guidance purposes only and whilst every care has been taken to ensure their accuracy, they should not be relied upon and potential buyers are advised to recheck the measurements.

