



Property Summary

*** No Chain *** Well proportioned mid town house for sale in Eyres Monsell closely located to the local school and on a regular bus route. The accommodation comprises porch, entrance hall, lounge, kitchen, three bedrooms, shower room, rear garden and off road parking. An ideal starter or family home!



GROUND FLOOR
390 sq.ft. (36.2 sq.m.) approx.

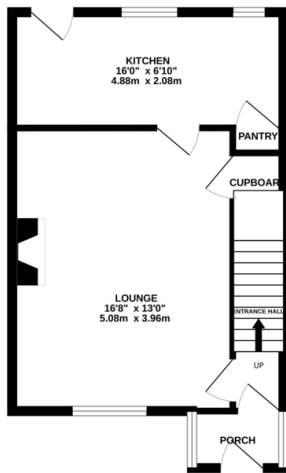

1ST FLOOR
420 sq.ft. (39.0 sq.m.) approx.

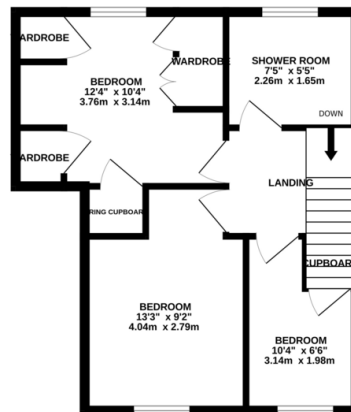

TOTAL FLOOR AREA: 810 sq.ft. (75.2 sq.m.) approx.

Whilst every attempt has been made to ensure the accuracy of the floorplan contained here, measurements of doors, windows, rooms and any other items are approximate and no responsibility is taken for any error, omission or mis-statement. This plan is for illustrative purposes only and should be used as such by any prospective purchaser. The services, systems and appliances shown have not been tested and no guarantee as to their operability or efficiency can be given.
Made with Metrage 02023

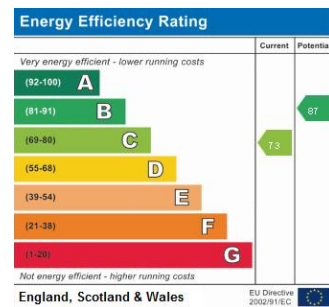

- No Chain
- Three Bedrooms
- Mid Town House
- Off Road Parking
- Room For Improvement
- Close To Amenities
- Good Size Rear Garden
- Ideal First Time Buy

phillips george | sales & lettings

Agents Note: Whilst every care has been taken to prepare these sales particulars, they are for guidance purposes only. All measurements are approximate and for general guidance purposes only and whilst every care has been taken to ensure their accuracy, they should not be relied upon and potential buyers are advised to recheck the measurements

46 Long Street, Wigston, Leicestershire, LE18 2AH

info@phillipsgeorge.co.uk
0116 216 8178

