



Christian Street, E1

£325,000

A bright studio apartment situated on the second floor. The property features a modern open-plan living and kitchen area with wooden flooring, leading onto a private balcony with courtyard views. There is a semi-separate bedroom area with built-in storage, floor-to-ceiling windows throughout, and a well-appointed family bathroom. Residents also benefit from access to an on-site gym and a day porter.

The property is conveniently located a short distance from Aldgate (Circle and Metropolitan lines) and Aldgate East (District and Hammersmith & City lines), with Shadwell nearby for DLR connections. The area also offers a wide selection of bars, restaurants, and cafés.

Features

- Studio apartment
- Chain Free
- Secure Development
- On-Site Concierge
- Private Balcony
- Residents Gym

Christian Street,
London, E1

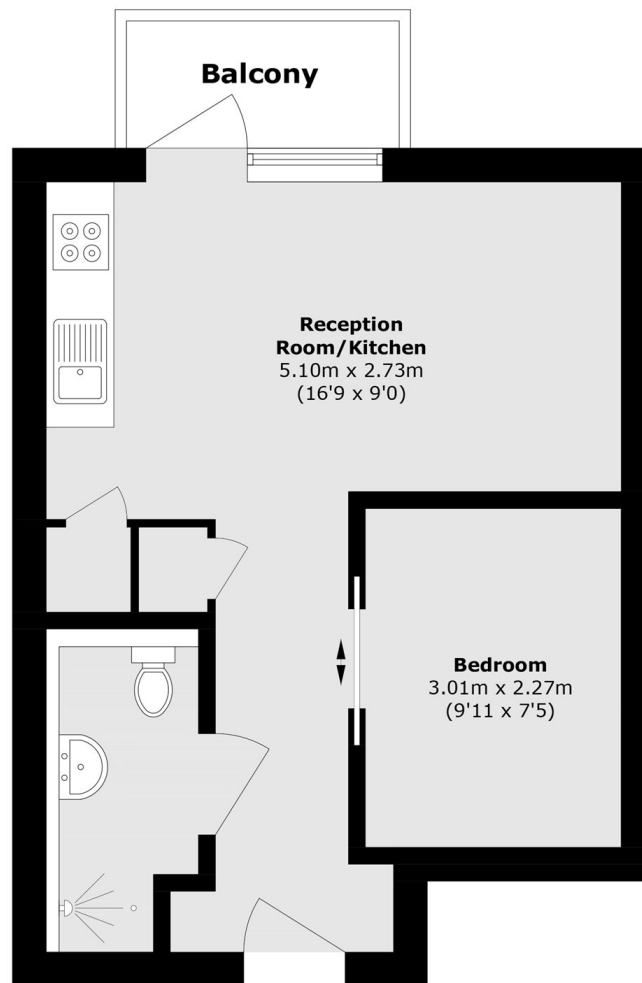

Total area (approx.): 33.0 sq. m (355.2 sq. ft)

Balcony area (approx.): 2.7 sq. m (29.0 sq. ft)

Dexters

Shoreditch
44 Great Eastern Street
London
EC2A 3EP
Sales
0207 483 6371

Energy Rating: . We aim to make our particulars both accurate and reliable. However they are not guaranteed; nor do they form part of an offer or contract. If you require clarification on any points then please contact us, especially if you're traveling some distance to view. Please note that appliances and heating systems have not been tested and therefore no warranties can be given as to their good working order.

 **RICS** | Regulated
Estate Agent
and Letting Agent

[dexters.co.uk](https://www.dexters.co.uk)