



Adelina Grove, E1

£425,000

A spacious two bedroom apartment located central to Whitechapel. This flat provides a spacious reception room with large windows and space for dining, a semi separate kitchen, two good sized bedrooms and a family bathroom. The property features wooden flooring, built in storage and painted brick walls throughout.

Located a short distance from Whitechapel station (Elizabeth line, Windrush line, Hammersmith&City line), this property offers a multitude of transport links throughout the City and further afield. The green spaces of Stepney City Farm and Weavers Fields are both nearby, as well as a selection of cafés, restaurants and bars.

Features

- Share of Freehold
- Two Bedrooms
- Convenient Location
- Great Transport Links
- Built In Storage
- Modern Kitchen

Adelina Grove, London, E1

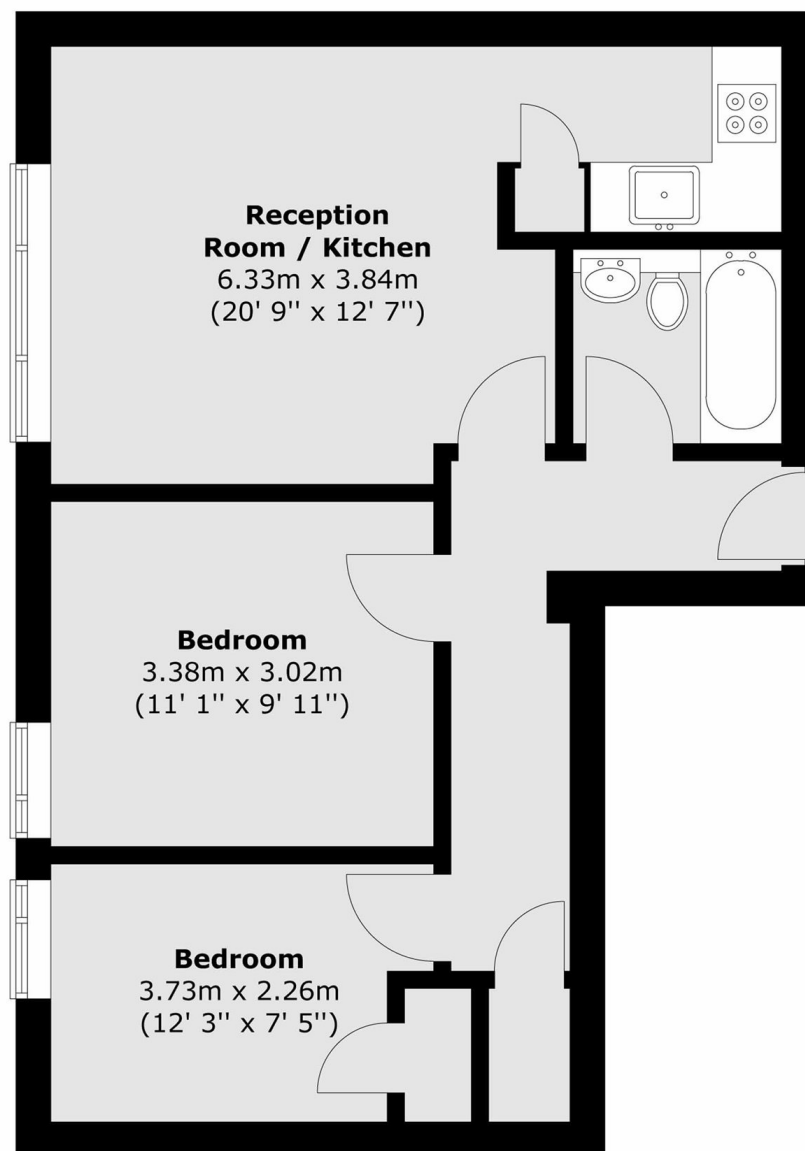

Total area (approx.) : 51.6 sq. m (555 sq. ft)