



Diss Street, E2

£2,850 Per calendar month

This one bedroom apartment is located on the 3rd floor of this Grade II-listed block, walking distance to Hoxton Overground station. This property has modern touches throughout, a separate kitchen/ living space and is within 200 yards of Columbia Road.

Located within a quarter of a mile from Hoxton Overground station and Columbia Road, the property has excellent connections into the City with restaurants and bars all close by.

Features

- Double Bedroom
- Modern Bathroom
- Secure Entry
- Lift Access
- Furnished
- Close to Columbia Road

Diss Street, London, E2

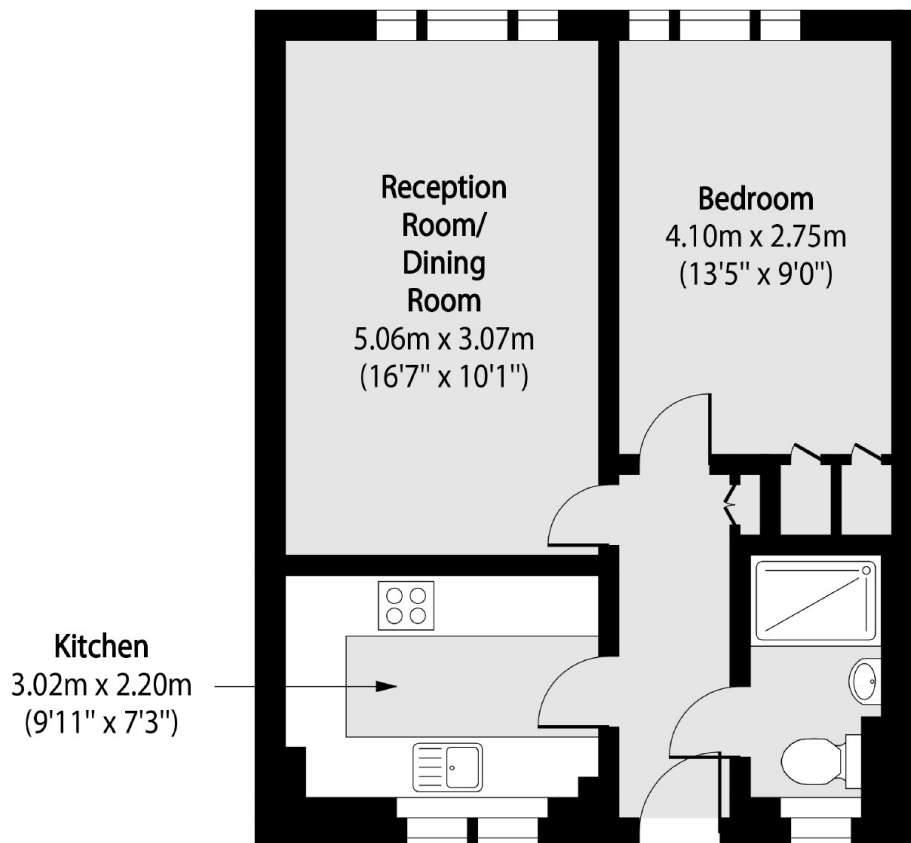

Total area (approx): 44.70 sq m (481 sq. ft)