

Sidney Street, E1

£450,000

A spacious three double bedroom apartment, with separate kitchen and living room. The property also benefits from a private south facing balcony and communal gardens.

The property is located close to The Royal London Hospital, Shadwell DLR and Whitechapel Station. Stepney Green Park is a short walk from the apartment. Additionally, Limehouse Station and Aldgate East Tube are only 0.8 miles away.

Features

- Three Double Bedrooms
- Private Balcony
- Separate Kitchen
- Double Glazing Windows
- Low Rise Block
- Dual Aspect

Sidney Street, London, E1

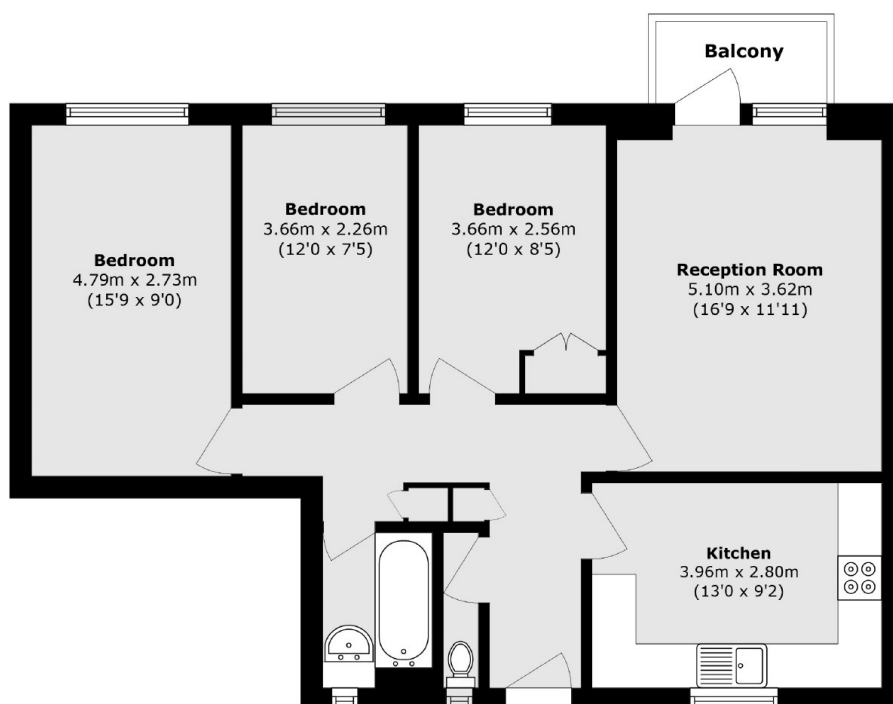

Total area (approx.): 77.7 sq. m (836.3 sq. ft)

Balcony area (approx.): 2.6 sq. m (27.9 sq. ft)