



## Palmers Road, E2

### £575,000

A two bedroom apartment on the sixth floor located on the popular Palmers Road. This property offer a semi open plan kitchen/reception with direct access to the expansive private balcony with far reaching views of Canary Wharf. The property has high quality finishes, floor to ceiling windows with plenty of natural sunlight, two good sized double bedrooms, one of which also provides access to the balcony, and built in storage throughout.

Located on the sought after Palmers Road, this property is a short distance from Mile End District, Hammersmith&City and Cetral Line) and Bethnal Green (Central Line) for easy access throughout the City, as well as the green spaces of Meath Gardens, Regents canal and Victoria Park.

### Features

- Two Double Bedrooms
- Modern Kitchen
- Large Private Balcony
- Secure Undergoing Parking
- Concierge Services
- Built In Storage

# Palmers Road, London, E2

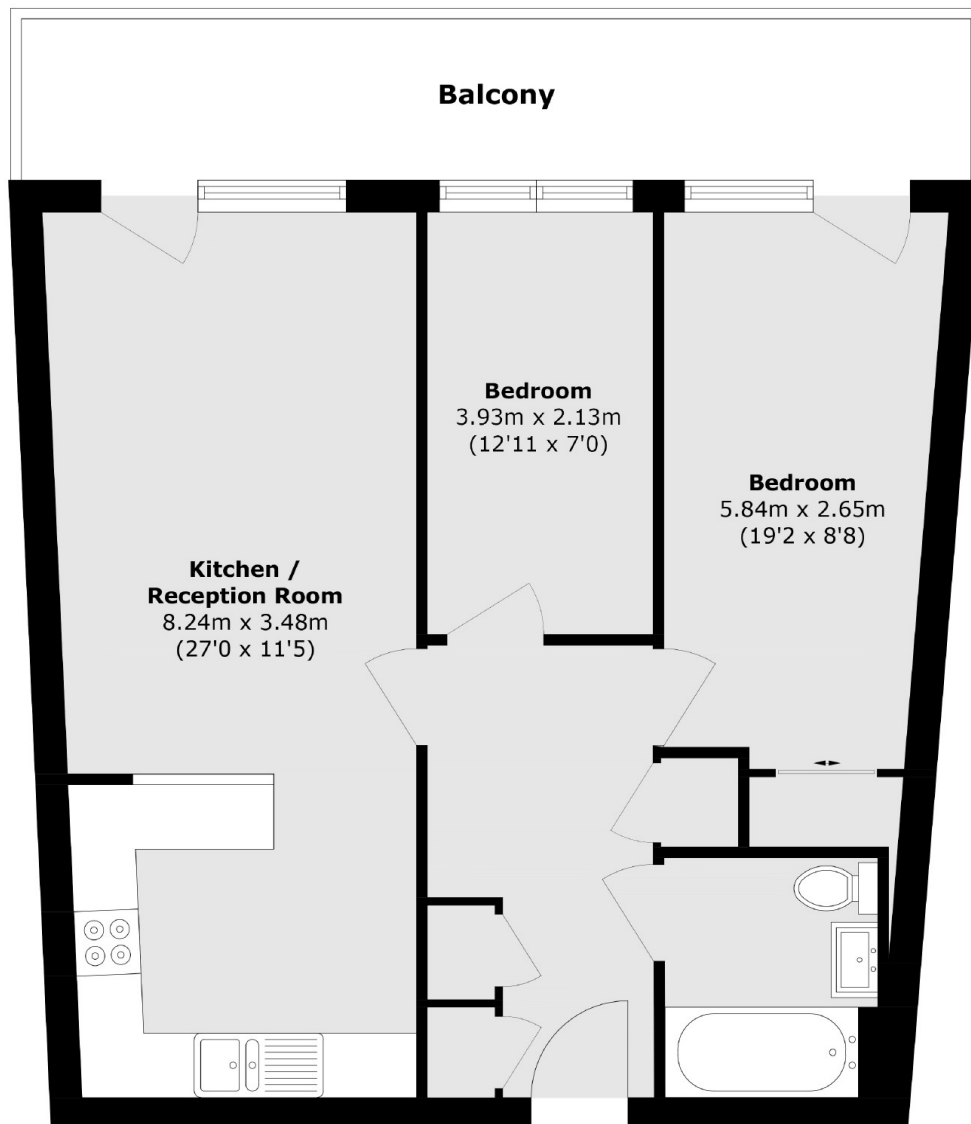

Total area (approx.): 65.2 sq. m (701.8 sq. ft)  
Balcony area (approx.): 13.2 sq. m (142.0 sq. ft)

## Dexters

Shoreditch  
44 Great Eastern Street  
London  
EC2A 3EP  
Sales  
0207 483 6371

Energy Rating: B. We aim to make our particulars both accurate and reliable. However they are not guaranteed; nor do they form part of an offer or contract. If you require clarification on any points then please contact us, especially if you're traveling some distance to view. Please note that appliances and heating systems have not been tested and therefore no warranties can be given as to their good working order.

 **RICS** | Regulated  
Estate Agent  
and Letting Agent

[dexters.co.uk](https://www.dexters.co.uk)