



New Drum Street, E1
£980,000

Dexters



New Drum Street, E1

A large two bedroom apartment on the eighth floor of this recently built development, Aldgate Place. The property benefits from a spacious open plan reception room, winter garden, two double bedrooms with built in storage and two well finished bathrooms, one with en-suite. Further benefits include a 24 hour concierge, residents gym and communal roof terrace.

Situated adjacent to Aldgate East Station, this property is ideally situated within close proximity to the array of shops and restaurants found in Aldgate Place. Nearby is the iconic Spitalfields Market, the hub of Liverpool Street, and the vast amenities of Shoreditch.

Features

- Two Double Bedrooms
- Two Bathrooms
- Winter Garden
- 24 Hour Concierge
- Residents Gym
- Communal Roof Terrace



New Drum Street, London, E1

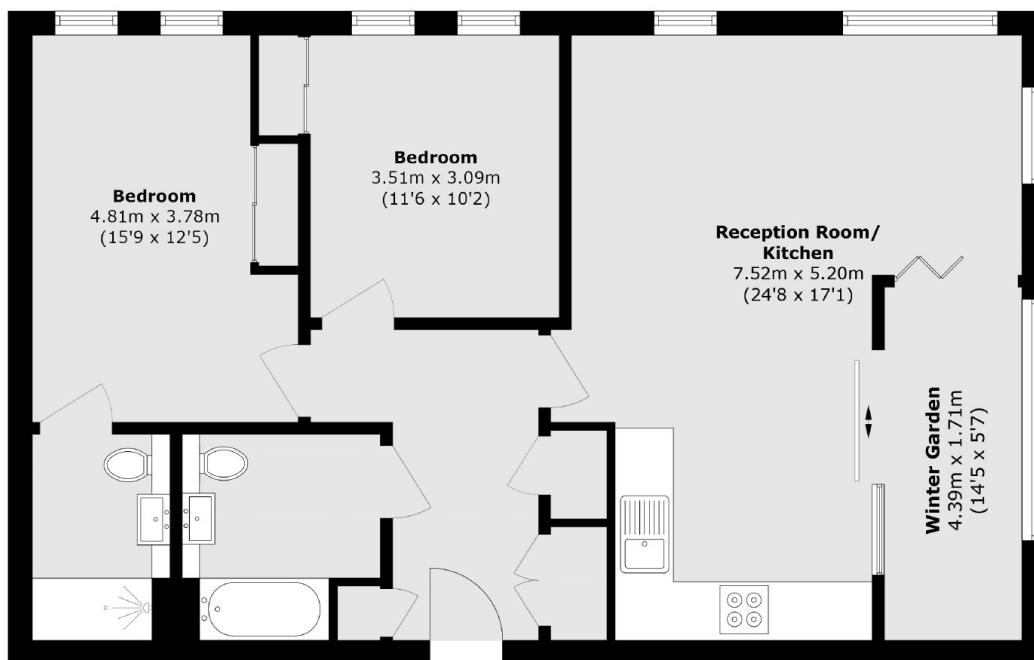

Total area (approx.): 92.3 sq. m (993.5 sq. ft)

Dexters

Shoreditch
44 Great Eastern Street
London
EC2A 3EP
Sales
0207 483 6371

Energy Rating: B. We aim to make our particulars both accurate and reliable. However they are not guaranteed; nor do they form part of an offer or contract. If you require clarification on any points then please contact us, especially if you're traveling some distance to view. Please note that appliances and heating systems have not been tested and therefore no warranties can be given as to their good working order.

 **RICS** | Regulated
Estate Agent
and Letting Agent

[dexters.co.uk](https://www.dexters.co.uk)