



## Candle Street, E1

£238,000

This bright, one bedroom property comprises of a spacious reception room with room to dine leading to a private balcony, a semi open plan fitted kitchen with integrated appliances, a double bedroom with built in wardrobes, and family bathroom. The property benefits from double glazing throughout and lift access.

Ideally located between three stations; Stepney Green, Mile End and Limehouse there is a choice of convenient links into Canary Wharf, Central London and beyond. A variety of open green space nearby includes Mile End Park, extending to Victoria Park, the Regents Canal and River Thames path all close by. There is also a variety of local schools, as well as plenty of local restaurants, bars, galleries and markets creating a vibrant and versatile setting.

### Features

- One Bedroom Apartment
- Private Balcony
- Modern Interiors
- Sought After Location
- Ample Storage
- Great Transport Links

Candle Street,  
London, E1

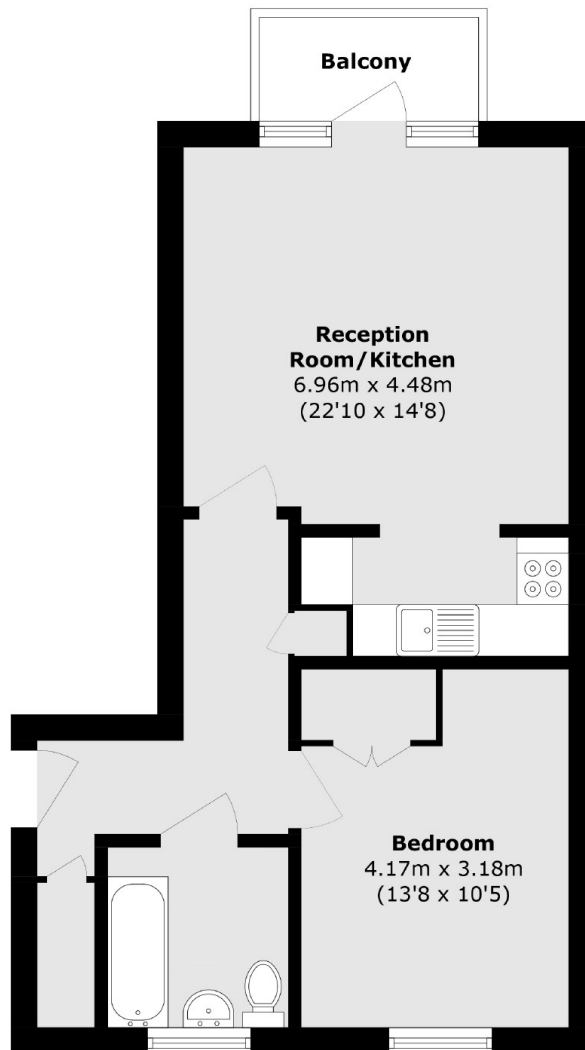

Total area (approx.): 51.5 sq. m (554.3 sq. ft)  
Balcony area (approx.): 3.0 sq. m (32.2 sq. ft)

**Dexters**

Shoreditch  
44 Great Eastern Street  
London  
EC2A 3EP  
Sales  
0207 483 6371

Energy Rating: B. We aim to make our particulars both accurate and reliable. However they are not guaranteed; nor do they form part of an offer or contract. If you require clarification on any points then please contact us, especially if you're traveling some distance to view. Please note that appliances and heating systems have not been tested and therefore no warranties can be given as to their good working order.

 **RICS** | Regulated  
Estate Agent  
and Letting Agent

[dexters.co.uk](https://www.dexters.co.uk)