

## Bridgewater Square, EC2Y

£600,000

A well proportioned two bedroom, two bathroom apartment in a popular location in the City. With equal sized bedrooms, separate fully integrated kitchen and a daytime porter, this is a great property for professionals. The property has bright interiors and a juliette balcony.

The Cobalt Building is located less than a quarter of a mile from Barbican underground station, less than half a mile to Farringdon Station and just over half a mile from both Moorgate and Old Street Stations.

### Features

- Two Bedrooms
- Two Bathroom
- Daytime Porter
- Juliet Balcony
- Close To The Station
- Quiet Cul-De-Sac Location

# Bridgewater Square, London, EC2Y

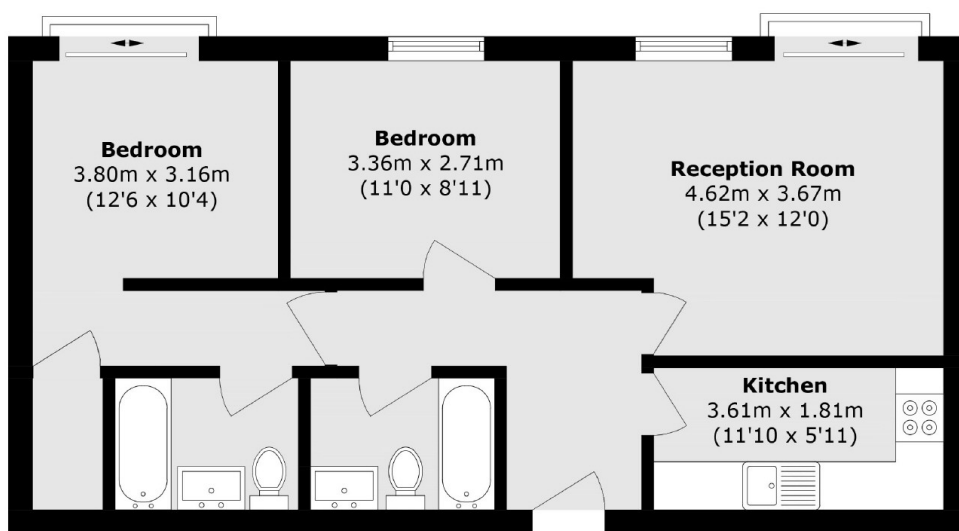

Total area (approx.): 63.3 sq. m (681.3 sq. ft)