



Brick Lane, E2

£950,000

A Freehold, three bedroom townhouse located at the top of Brick Lane. The ground floor consists of a family bathroom, utility cupboard and open plan kitchen/diner with concertina doors out to the private rear west facing garden. On the first floor there is a second bedroom and reception room with wood floors.

This townhouse is in the heart of Shoreditch with the Overground under a quarter of a mile away as too are the restaurants, bars and boutiques of Columbia Road and Redchurch Street.

Features

- Three Double Bedrooms
- Two Bathrooms
- West Facing Garden
- Off Street Parking
- No Onward Chain
- Kitchen/Diner
- Freehold



Brick Lane, E2

The top floor provides two more bedrooms, including the principle bedroom which features built in wardrobes. The property has a modern finish throughout and a neutral decor. There is off street parking to the front of the property.



Brick Lane, London, E2

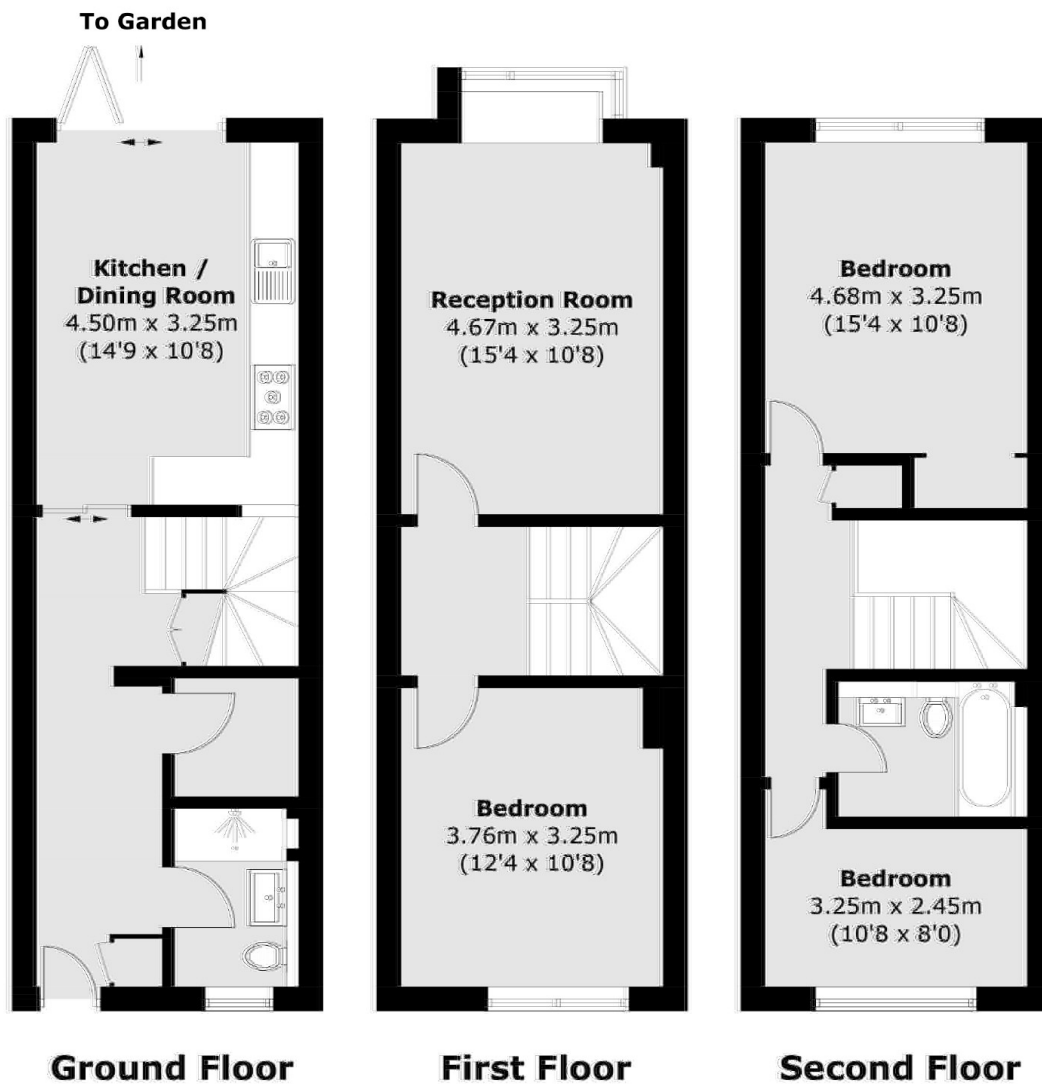

Total area (approx.): 102.6 sq. m (1,104.3 sq. ft)

Dexters

Shoreditch
44 Great Eastern Street
London
EC2A 3EP
Sales
0207 483 6371

Energy Rating: C. We aim to make our particulars both accurate and reliable. However they are not guaranteed; nor do they form part of an offer or contract. If you require clarification on any points then please contact us, especially if you're traveling some distance to view. Please note that appliances and heating systems have not been tested and therefore no warranties can be given as to their good working order.

 **RICS** | Regulated
Estate Agent
and Letting Agent

[dexters.co.uk](https://www.dexters.co.uk)