



East Arbour Street, E1 £350,000

A one bedroom apartment located within the grade listed courthouse conversion of Whittington Apartments. The property has an open plan kitchen and living area, wooden style flooring throughout, secure entry and is sold chain free.

East Arbour Street is located just over half a mile from Whitechapel Station where you will find the Elizabeth Line with fantastic links to the City and Heathrow Airport. Limehouse DLR Station is also half a mile away giving you links to Canary Wharf and The City. The Royal London hospital is close by as well as all the shops that Commercial Road has to offer.

Features

- One Bedroom
- Grade Listed
- Storage Throughout
- Secure Access
- Sold Chain Free
- Conversion

East Arbour Street,
London, E1

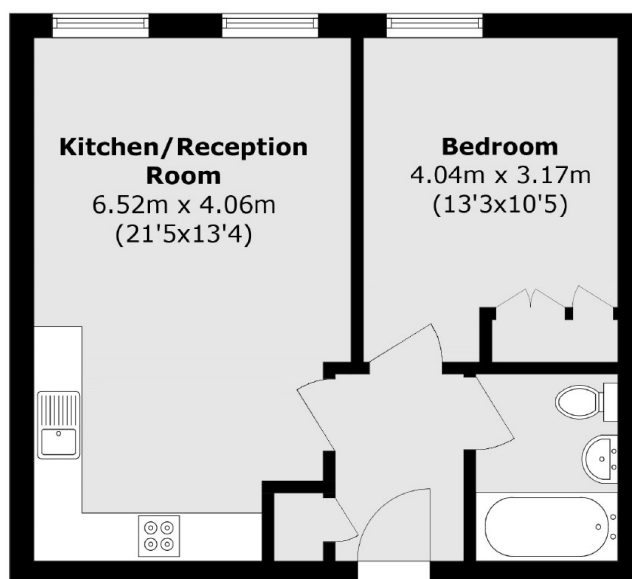

Total area (approx.): 47.4 sq. m (510.2 sq. ft)