



Weymouth Terrace, E2

£575 Per week

A four bedroom maisonette located off Hackney Road. The property which is split over two levels has a large open plan reception and kitchen area, four double bedrooms and a private garden.

Ideally located moments from Hoxton station and the trendy bars, restaurants and boutiques in Shoreditch and the City.

Features

- Four Double Bedrooms
- Separate Kitchen
- Furnished
- Large Reception
- Amazing Location
- Maisonette

Weymouth Terrace, London, E2

Ground Floor

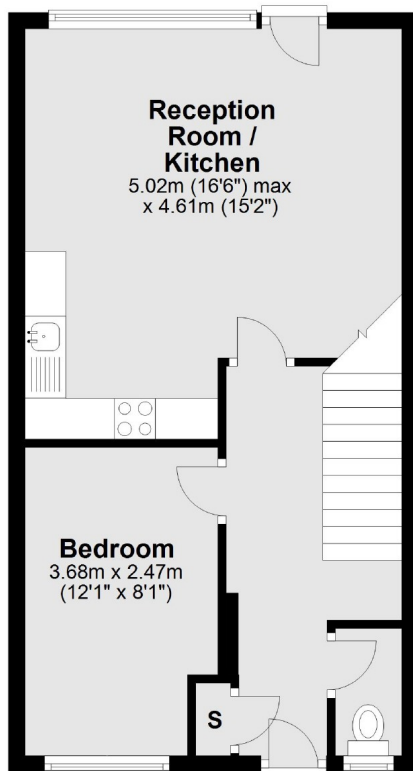

First Floor

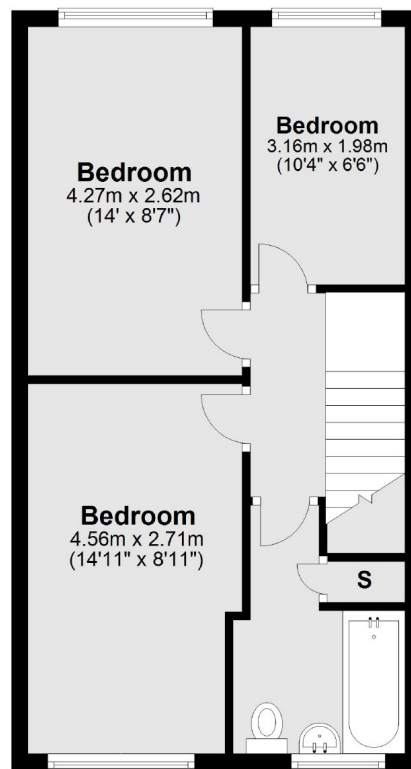

Total area: approx. 82.0 sq. metres (883.0 sq. feet)

Contact

To arrange a viewing call our office on the number below or visit our website.



Energy Rating: D. We aim to make our particulars both accurate and reliable. However they are not guaranteed; nor do they form part of an offer or contract. If you require clarification on any points then please contact us, especially if you're traveling some distance to view. Please note that appliances and heating systems have not been tested and therefore no warranties can be given as to their good working order.