



Roberta Street, E2

£325,000

A dual aspect, two bedroom, split level apartment situated on the 9th floor. This bright and spacious property is comprised of reception/dining room, balcony, separate kitchen, two double bedrooms, modern bathroom and separate WC.

Johnson Hose is a secure block located off Bethnal Green Road. The property benefits from being close to a range of shops, bars and transports links, as well as multiple green spaces.

Features

- City Views
- Double Glazing
- Two bedroom
- Lift access
- Balcony
- Secure Access

Roberta Street, London, E2

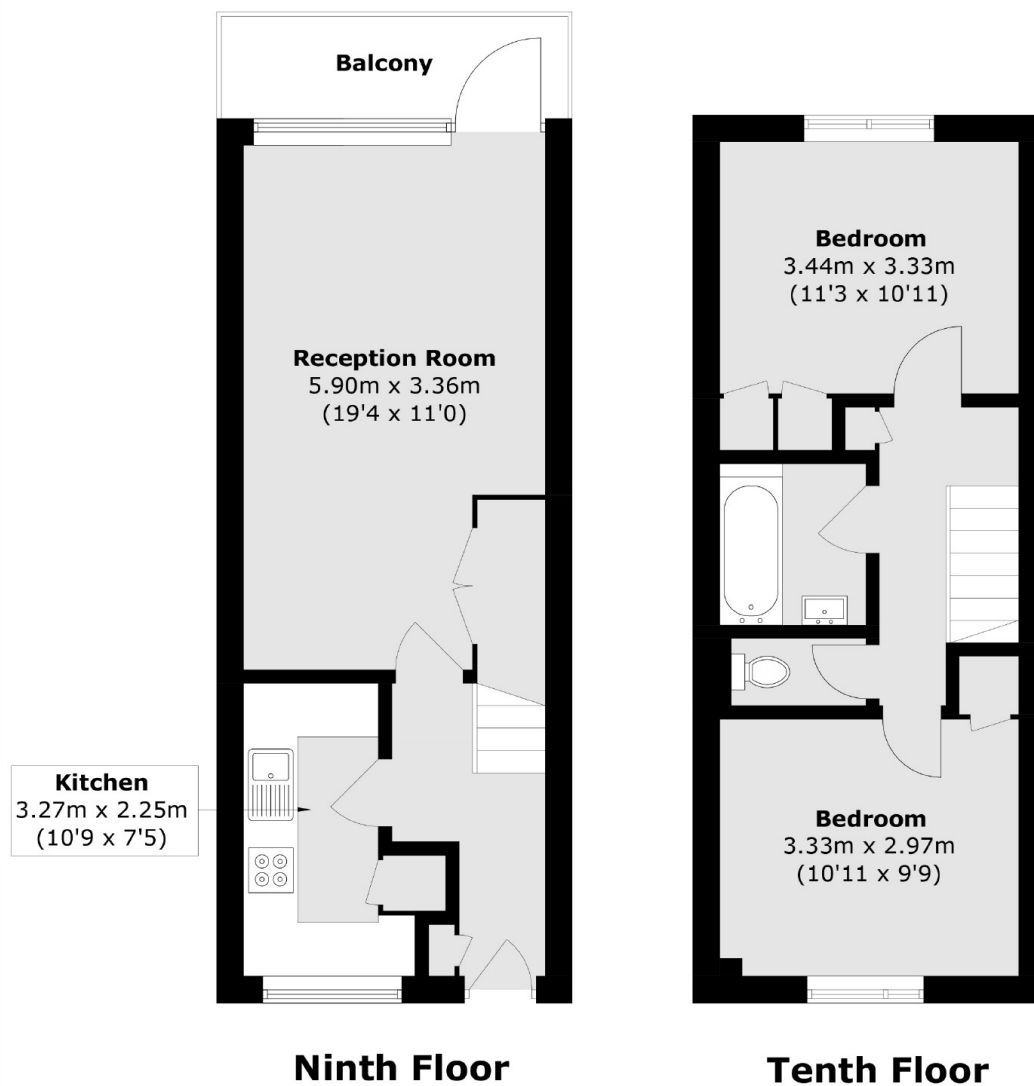

Total area (approx.): 62.4 sq. m (671.7 sq. ft)
Balcony: 4.4 sq. m (47.4 sq. ft)