



## Wheler Street, E1 £400,000

A modern, one double bedroom apartment located within a secure, purpose built development. This property features an open plan kitchen/living area, wooden floors throughout, and plenty of built in storage.

This apartment is located within a quarter of a mile of Old Spitalfields market which provides a selection of restaurants, cafés and bars. The property is a short walk from Shoreditch High Street Station (Overground), Old Street Station (Northern Line) and Liverpool Street Station (Elizabeth Line).

### Features

- Lift Access
- Good Transport Links
- Secure Development
- Double Bedroom
- Wooden Flooring
- Built in Storage

# Wheler Street, London, E1

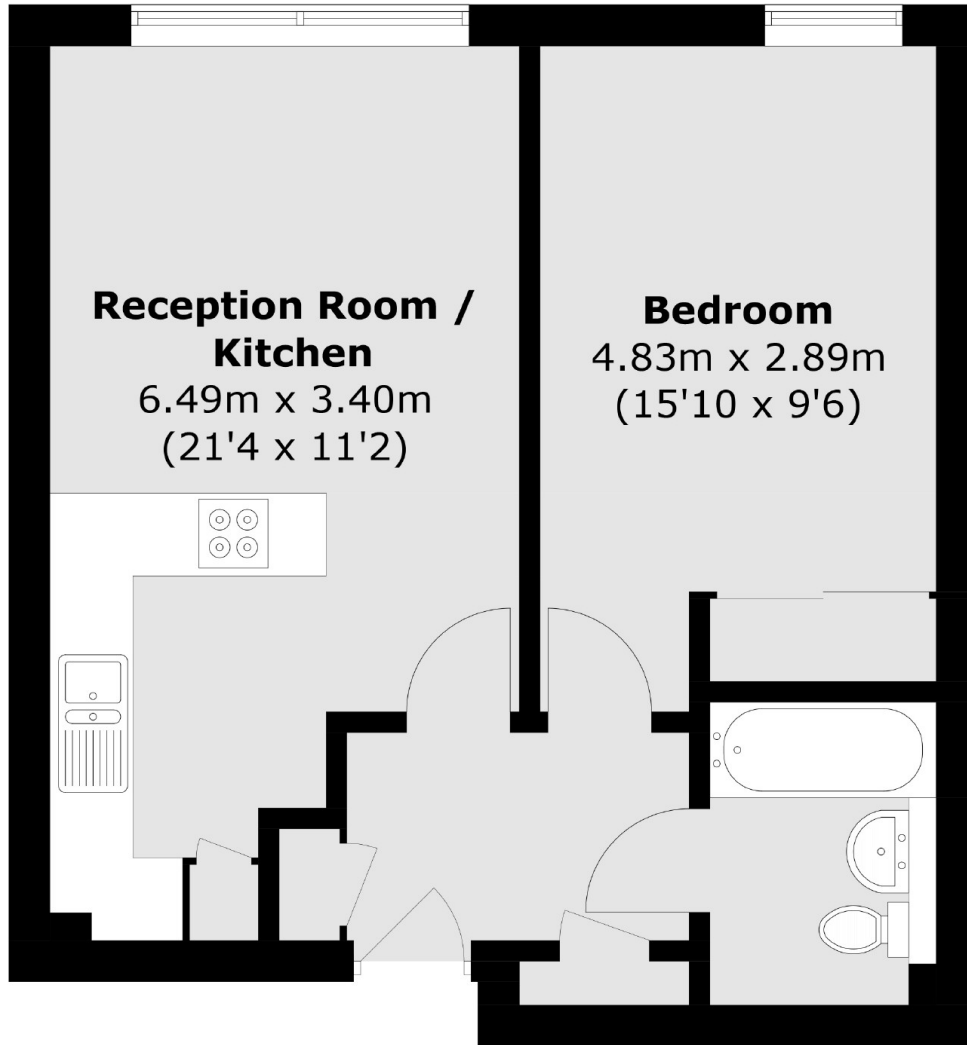

Total area (approx.): 43.2 sq. m (465.0 sq. ft)